

apexco[®]
pump
MADE IN TURKEY



ISO
9001
QUALITY
ASSURANCE

www.apexco.com.tr



2017 yılında kurulan firmamız, APEXCO markası ile paslanmaz çelik santrifüj pompa sektöründe, 15 yıldan fazla deneyimiyle, 316, 316L

ve 304 paslanmaz çelikten mamül, tek kademeli ve çift kademeli pompa üretimi yapmaktadır. Talebe göre; açık fanlı santrifüj pompa, kapalı fanlı santrifüj pompa veya yarı açık fanlı santrifüj pompalar üretmekteyiz. Üretimimizde, hammadde temininin %100'ünü yerli tedarikçilerden sağlıyoruz. Böylelikle, hammadde ve tamamen yerli iş gücü ile imalat aşamasının her noktasında azami temizlikten ödün vermemeyerek, sektördeki yerimizi sağlamlaştırmaya devam ediyoruz. Üretim merkezimiz İstanbul'da olmakla beraber ülkemizin bir çok ilinde, bayi ağı organizasyonları ile siz değerli müşterilerimize, ürünlerimizi en hızlı şekilde ulaştırmak amacıyla, demonte pompa stoğu tutuyoruz, böylelikle, hızlı üretim kabiliyetimizi sürekli olarak dinamik tutmayı hedefliyoruz.

İmalatımızın her aşamasında gerekli tüm testleri titizlikle yaparak “%100 sorunsuz ürünler” politikamızla üretilen ürünlerimizi siz değerli müşterilerimizin teveccühlerine sunarız...

Founded in 2017 our company is producing by APEXCO Brand 316, 316L and 304 stainless steel, single stage and 2 stages centrif-

ugal pumps also we can produce open impeller centrifugal pumps, closed impeller centrifugal pumps or half close impeller centrifugal pumps with more than 15 years experience. We continue to consolidate our market position via supplying %100 of raw materials from the local market and we don't make concessions our production quality policies. Facility is located in Istanbul, to provide faster supplying we are keeping uninstalled pump stock in our hand and we continue to expend our marketing organisation all over of country. Via this way, we attend to introduce dynamic production ability.

We are kindly introduce the pumps produced by strictly tested in every stage of the production with the our policy of “%100 smooth-ly products”.



AST SERİSİ

P-AST, D-AST, G-AST
AÇIK FANLI POMPALAR
OPEN IMPELLER CENTRIFUGAL PUMPS

04-05**S-AST SERİSİ**

AÇIK FANLI POMPALAR
OPEN IMPELLER CENTRIFUGAL PUMPS

06-07**M-AST SERİSİ**

AÇIK FANLI POMPALAR
OPEN IMPELLER CENTRIFUGAL PUMPS

08-09**T-KST SERİSİ**

TUZ POMPALAR
SALT PUMPS

10**H-AST SERİSİ**

HAŞIL POMPALAR
HASIL PUMPS

11**Y-KST SERİSİ**

YARI KAPALI POMPALAR
HALF CLOSED PUMPS

12

KST SERİSİ 1500 DK/DEVİR (L/MİN)
KAPALI FANLI POMPALAR
IMPELLER CENTRIFUGAL PUMPS

13-25

KST SERİSİ 3000 DK/DEVİR (L/MİN)
KAPALI FANLI POMPALAR
IMPELLER CENTRIFUGAL PUMPS

26-34**2M-KST SERİSİ**

2 KADEMELİ POMPALAR
2 STAGE PUMPS

36**3M-KST SERİSİ**

3 KADEMELİ POMPALAR
3 STAGE PUMPS

37**SF SERİSİ****38****JET SU SERİSİ****39****P-JET SU SERİSİ****40****2WCO SERİSİ**

2 KADEMELİ POMPALAR
2 STAGE PUMPS

41**CTM SERİSİ**

MANYETİK KAPLİNLİ POMPALAR
PUMPS WITH MAGNETIC COUPLING

42-43

AST SERİSİ

AST SERIES
2900 d/dak (l/min)



PERFORMANS TABLOSU

PERFORMANCE TABLE

POMPA TİPİ PUMP TYPE	kw	GİRİŞ-ÇIKIŞ	m ³ /h	0	3	5	7	9
P-AST 15/80	0,18	1/2"-1/2"	H[m]	9	7,2	6	4,7	3,2

POMPA TİPİ PUMP TYPE	kw	GİRİŞ-ÇIKIŞ	m ³ /h	0	3	5	7	9
D-AST 15/80	0,18	3/4"-1/2"	H[m]	9	7,2	6	4,7	3,2

POMPA TİPİ PUMP TYPE	kw	GİRİŞ-ÇIKIŞ	m ³ /h	0	3	5	8	10	12	14
G-AST 20/100	0,37	1"-3/4"	H[m]	10	8,5	7,4	5,5	4,2		
	0,55	1"-3/4"		11,5	10	8,9	7,2	6	4,7	
	0,75	1"-3/4"		13	11,5	10,5	8,9	7,8	6,5	5,3

KULLANIM ALANLARI

USAGE AREAS

Endüstriyel tip bulaşık ve çamaşır makinelerinde
Bol debili yıkama sistemlerinde
İçme suyu ve dolum tesislerinde
Isıtma ve soğutma sistemlerinde
Kapalı devre soğutma (Chiller) sistemlerinde
Boyahanelerde boya ve boyalı sıvı basımında
Gıda endüstrisinde (meşrubat, meyve suyu ve süt fabrikalarında)
Isıtma ve hava şartlandırma sistemlerinde
Glikol çözeltilerini basmada
Az aşındırıcı endüstriyel ve kimyasal sıvılarda
Biodizel tesislerde
Baca gazı arıtma sistemlerinde
Meyve ve sebze yıkama makinalarında
Çelik tencere imalatında
Kuryemiş tuzlama işlemlerinde

Industrial type dishwashers and washing machines
In high flow washing systems
Drinking water and filling facilities
In heating and cooling systems
In closed circuit cooling (Chiller) systems
In dye and dyed liquid printing in dyehouses
In the food industry (beverage, juice and dairy factories)
Heating and air conditioning systems
Pressing glycol solutions
In less corrosive industrial and chemical liquids
Biodiesel in plants
In flue gas treatment systems
In fruit and vegetable washing machines
In the manufacture of steel pots
Nuts salting processes

P AST 15/60
 PERFORMANS EĞRİLERİ

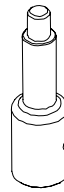
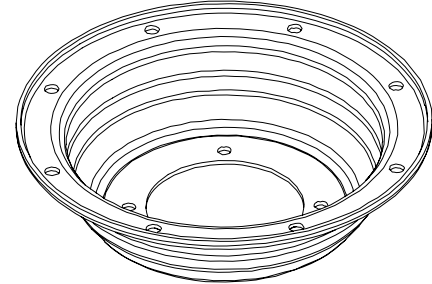
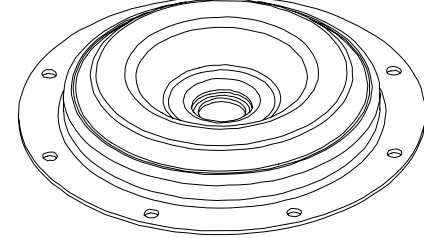
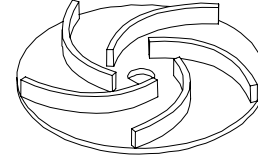
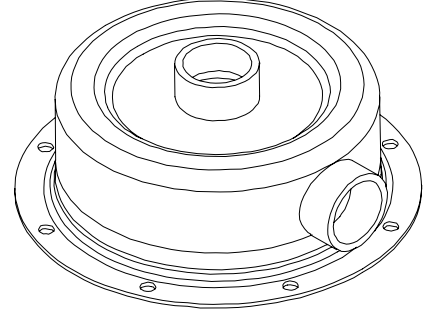
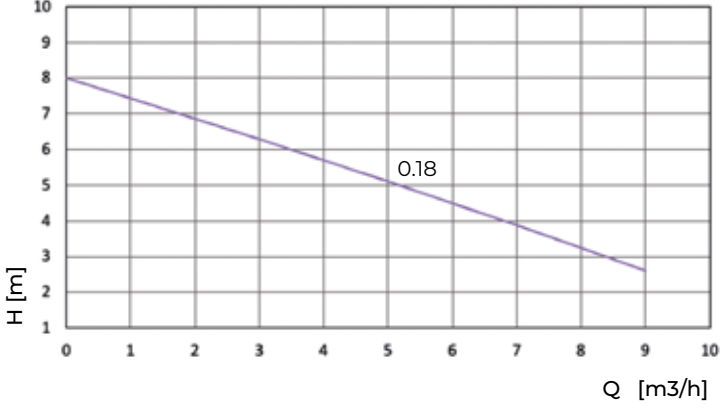
 GİRİŞ(INPUT): 1/2" ÇIKIŞ(OUTPUT): 1/2" **2900 d/dak (l/min)**

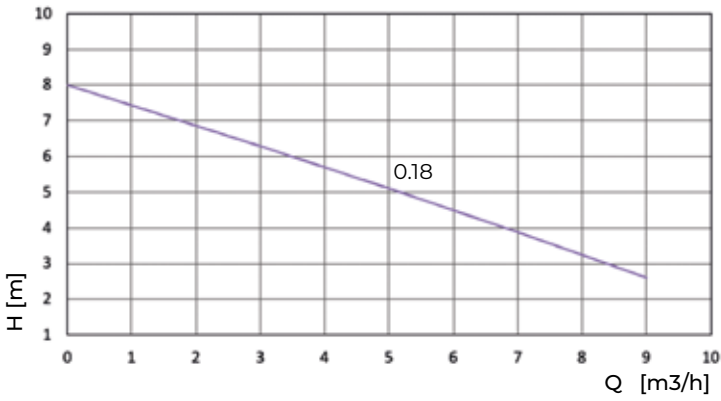
D AST 15/80
 PERFORMANS EĞRİLERİ

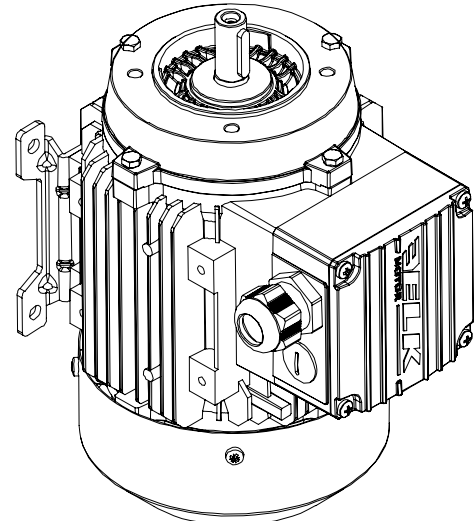
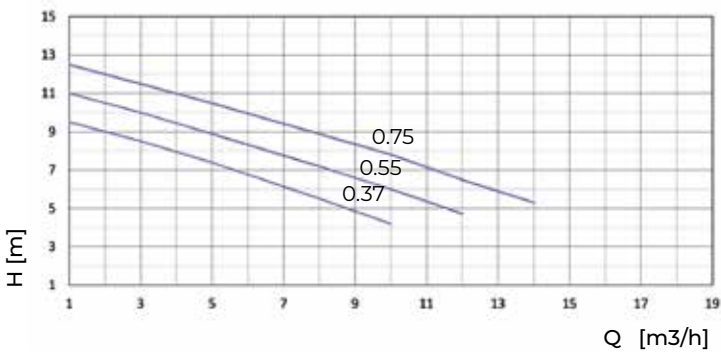
 GİRİŞ(INPUT): 3/4" ÇIKIŞ(OUTPUT): 1/2" **2900 d/dak (l/min)**

G AST 20/100
 PERFORMANS EĞRİLERİ

 GİRİŞ(INPUT): 1" ÇIKIŞ(OUTPUT): 3/4" **2900 d/dak (l/min)**

S-AST SERİSİ

S-AST SERIES
2900 d/dak (l/min)



PERFORMANS TABLOSU PERFORMANCE TABLE

POMPA TİPİ PUMP TYPE	kw	GİRİŞ-ÇIKIŞ	m ³ /h	0	3	6	9	12	15	18
S-AST 25/150	0,75	1 1/4"-1"	H[m]	16,2	14,1	11,7	9,2	6,6		
	1,1	1 1/4"-1"		21,3	18,7	16,2	13,6	11	8,6	
	1,5	1 1/4"-1"		25,5	23,2	20,7	18,3	15,8	13,3	10,8

POMPA TİPİ PUMP TYPE	kw	GİRİŞ-ÇIKIŞ	m ³ /h	0	6	12	15	18	21	24
S-AST 32/150	0,75	1 1/2"-1 1/4"	H[m]	15	11,5	7,8	6	4		
	1,1	1 1/2"-1 1/4"		19,5	15,7	12	10	8,2	6,3	
	1,5	1 1/2"-1 1/4"		23	19,5	15,9	13,9	12	10	8,2

POMPA TİPİ PUMP TYPE	kw	GİRİŞ-ÇIKIŞ	m ³ /h	0	6	12	18	24	33	44
S-AST 40/115	0,75	1 1/2"-1 1/2"	H[m]	14	12,2	10	8,6	6,8		
	1,1	1 1/2"-1 1/2"		16	14,2	12	10,5	8,7	6,1	
	1,5	1 1/2"-1 1/2"		18	16,2	14	12,5	10,5	8	5

KULLANIM ALANLARI USAGE AREAS

Endüstriyel tip bulaşık ve çamaşır makinelerinde
Bol debili yıkama sistemlerinde
İçme suyu ve dolum tesislerinde
Isıtma ve soğutma sistemlerinde
Kapalı devre soğutma (Chiller) sistemlerinde
Boyahanelerde boya ve boyalı sıvı basımında
Gıda endüstrisinde (meşrubat, meyve suyu ve süt fabrikalarında)
Isıtma ve hava şartlandırma sistemlerinde
Glikol çözeltilerini basmada
Az aşındırıcı endüstriyel ve kimyasal sıvılarda
Biodizel tesislerde
Baca gazı arıtma sistemlerinde
Meyve ve sebze yıkama makinalarında
Çelik tencere imalatında
Kuruyemiş tuzlama işlemlerinde

Industrial type dishwashers and washing machines
In high flow washing systems
Drinking water and filling facilities
In heating and cooling systems
In closed circuit cooling (Chiller) systems
In dye and dyed liquid printing in dyehouses
In the food industry (beverage, juice and dairy factories)
Heating and air conditioning systems
Pressing glycol solutions
In less corrosive industrial and chemical liquids
Biodiesel in plants
In flue gas treatment systems
In fruit and vegetable washing machines
In the manufacture of steel pots
Nuts salting processes

S-AST 25/150
 PERFORMANS EĞRİLERİ

GİRİŞ(INPUT): 1 1/4" ÇIKIŞ(OUTPUT): 1" 2900 d/dak (l/min)

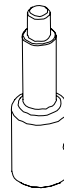
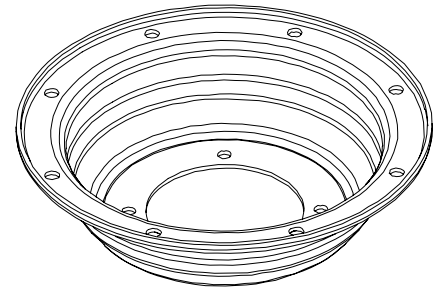
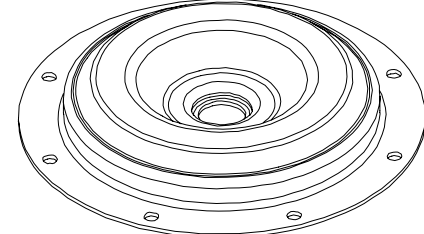
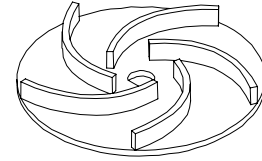
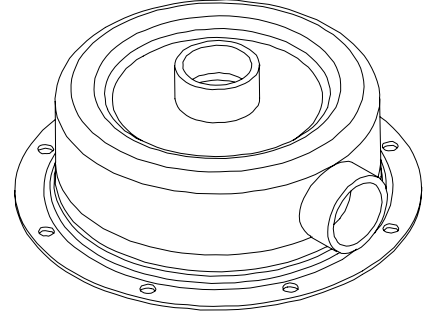
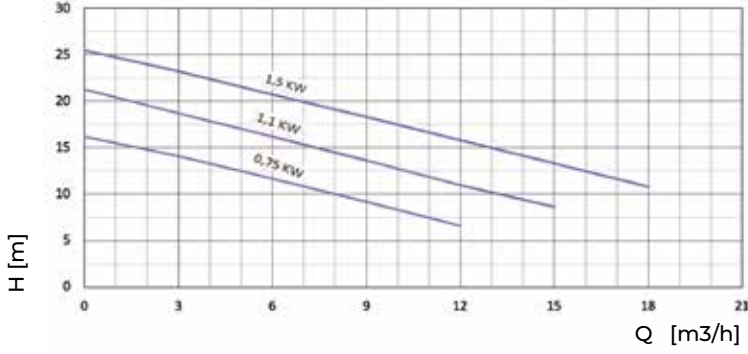
S-AST 32/150
 PERFORMANS EĞRİLERİ

GİRİŞ(INPUT): 1 1/2" ÇIKIŞ(OUTPUT): 1 1/4" 2900 d/dak (l/min)

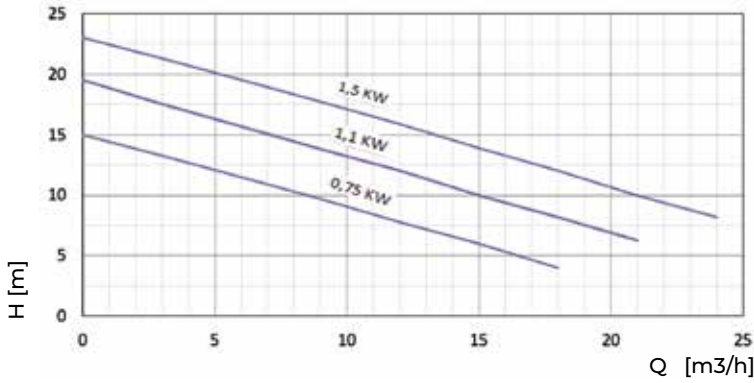

S-AST 40/115
 PERFORMANS EĞRİLERİ

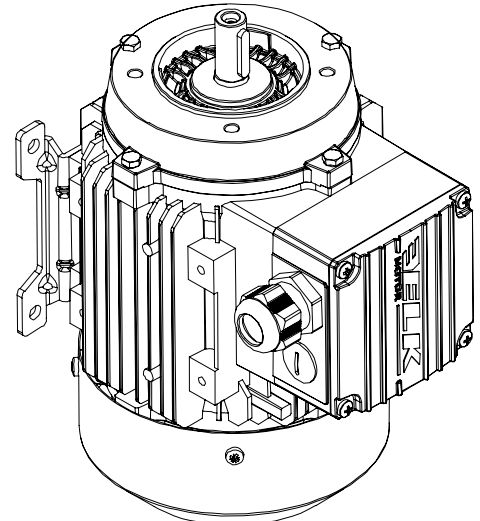
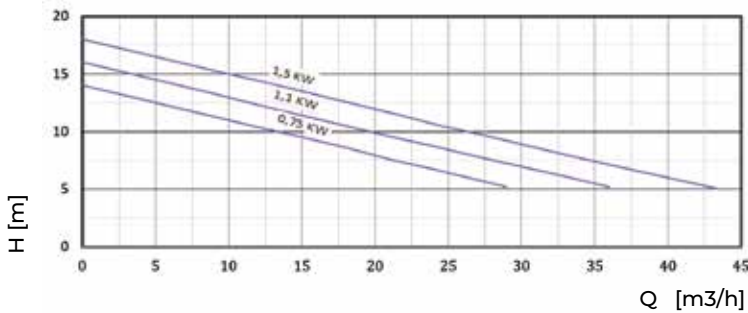
GİRİŞ(INPUT): 1 1/2" ÇIKIŞ(OUTPUT): 1 1/2" 2900 d/dak (l/min)

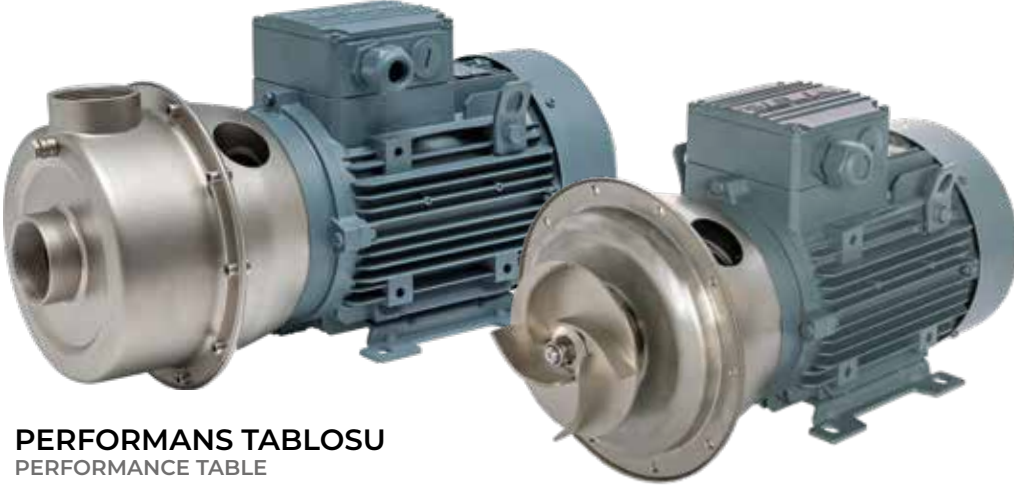

M-AST SERİSİ

M-AST SERIES
2900 d/dak (l/min)



PERFORMANS TABLOSU
PERFORMANCE TABLE

POMPA TİPİ PUMP TYPE	kw	GİRİŞ-ÇIKIŞ	m ³ /h	0	6	12	15	18	20	24	30	36
M-AST 32/160	1,5	1 1/2"-1 1/4"	H[m]	21,6	18,2	14,7	13					
	2,2	1 1/2"-1 1/4"		24	20,8	17,6	15,8	14	12,8			
	3	1 1/2"-1 1/4"		26,6	23,5	20,3	18,6	17	15,8	13,6		
	4	1 1/2"-1 1/4"		29,3	26,2	23	21,3	19,7	18,6	16,4	13	
	5,5	1 1/2"-1 1/4"		32	29	25,3	24,2	22,6	21,5	19,3	15,9	12,4

POMPA TİPİ PUMP TYPE	kw	GİRİŞ-ÇIKIŞ	m ³ /h	0	6	12	18	24	30	36	55
M-AST 40/130	1,5	1 1/2"-1 1/2"	H[m]	19	16,2	13,3	7,8				
	2,2	1 1/2"-1 1/2"		22	19	16	10,2	3,8			
	3	1 1/2"-1 1/2"		24	21	18,2	12,3	5,8	4		
	4	1 1/2"-1 1/2"		27,2	24	21	15,1	8,6	6,7	4	
	5,5	1 1/2"-1 1/2"		30	27	24	18	11,2	9,4	6,5	4

POMPA TİPİ PUMP TYPE	kw	GİRİŞ-ÇIKIŞ	m ³ /h	0	6	12	18	24	33	42	50	57	63	70
M-AST 50/115	1,5	2"-2"	H[m]	15,4	14	12,5	11,2	9,7	7,7	5,7				
	2,2	2"-2"		19	17,5	15,9	14,3	12,7	10,5	8,3	6,4			
	3	2"-2"		22,3	20,7	19	17,3	15,7	13,3	11	8,8	6,9		
	4	2"-2"		25,4	23,8	22,1	20,3	18,6	16	13,5	11,3	9,4	7,4	
	5,5	2"-2"		28,3	26,4	24,7	23	21,3	18,7	16	13,7	11,6	9,9	8

POMPA TİPİ PUMP TYPE	kw	GİRİŞ-ÇIKIŞ	m ³ /h	0	6	12	24	33	42	57	65	75
M-AST 50/130	2,2	2 1/2"-2"	H[m]	17	15,7	14,4	11,7	9,7	7,7			
	3	2 1/2"-2"		20	18,5	17	14,2	12	10	6,3		
	4	2 1/2"-2"		22,7	21,2	19,7	16,8	14,4	12,2	8,07	6,5	
	5,5	2 1/2"-2"		25,8	24,3	22,7	19,5	17,2	15	11,3	9,4	7

KULLANIM ALANLARI USAGE AREAS

Endüstriyel tip bulaşık ve çamaşır makinelerinde
Bol debili yıkama sistemlerinde
İçme suyu ve dolun tesislerinde
Isıtma ve soğutma sistemlerinde
Kapalı devre soğutma (Chiller) sistemlerinde
Boyahanelerde boya ve boyalı sıvı basımında
Gıda endüstrisinde (meşrubat, meyve suyu ve süt fabrikalarında)
Isıtma ve hava şartlandırma sistemlerinde
Glikol çözeltilerini basmada
Az aşındırıcı endüstriyel ve kimyasal sıvılarda
Biodizel tesislerde
Baca gazı arıtma sistemlerinde
Meyve ve sebze yıkama makinalarında
Çelik tencere imalatında
Kuruyemiş tuzlama işlemlerinde

Industrial type dishwashers and washing machines
In high flow washing systems
Drinking water and filling facilities
In heating and cooling systems
In closed circuit cooling (Chiller) systems
In dye and dyed liquid printing in dyehouses
In the food industry (beverage, juice and dairy factories)
Heating and air conditioning systems
Pressing glycol solutions
In less corrosive industrial and chemical liquids
Biodiesel in plants
In flue gas treatment systems
In fruit and vegetable washing machines
In the manufacture of steel pots
Nuts salting processes

M AST 32/160
 PERFORMANS EĞRİLERİ

GİRİŞ(INPUT): 1 1/2" ÇIKIŞ(OUTPUT): 1 1/4"

2900 d/dak (l/min)

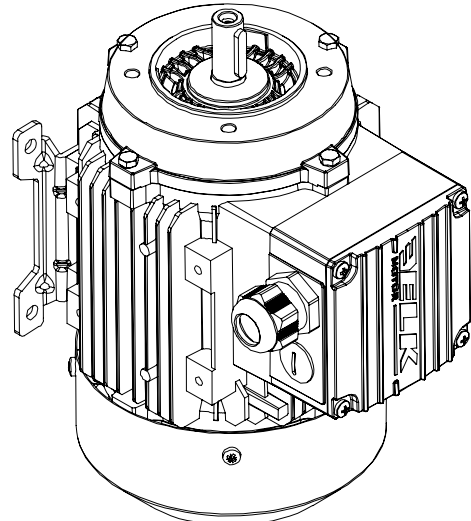
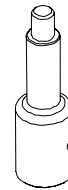
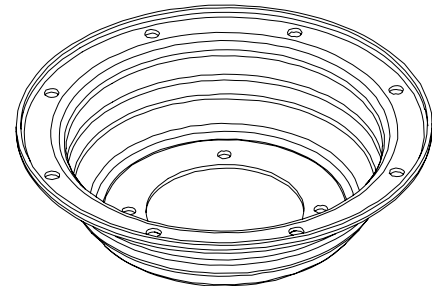
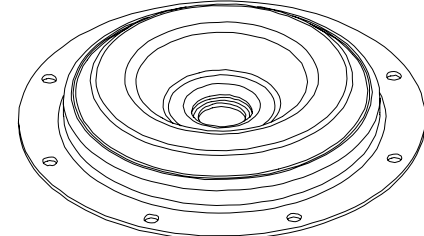
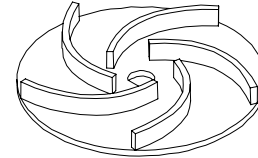
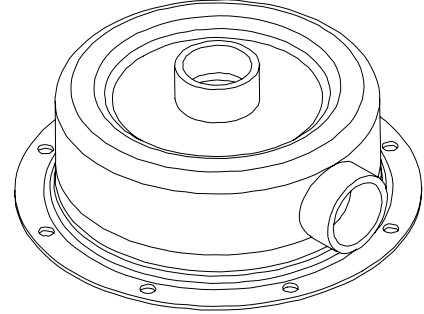
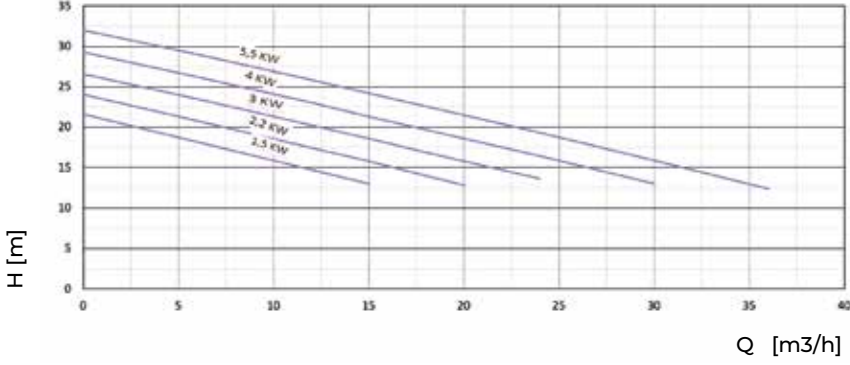
M AST 40/130
 PERFORMANS EĞRİLERİ

GİRİŞ(INPUT): 1 1/2" ÇIKIŞ(OUTPUT): 1 1/2"

2900 d/dak (l/min)

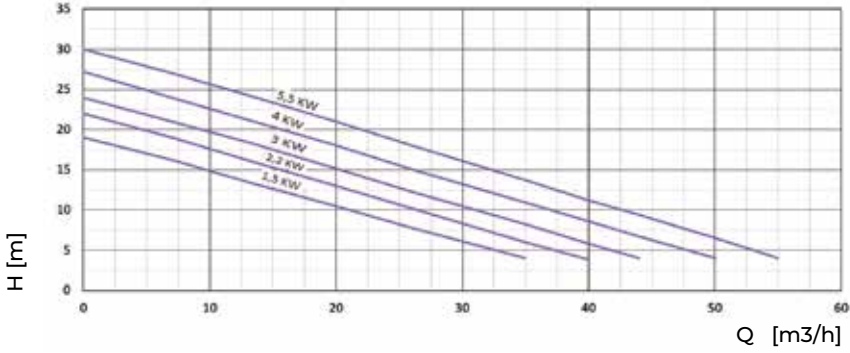
M AST 50/115
 PERFORMANS EĞRİLERİ

GİRİŞ(INPUT): 2" ÇIKIŞ(OUTPUT): 2"

2900 d/dak (l/min)

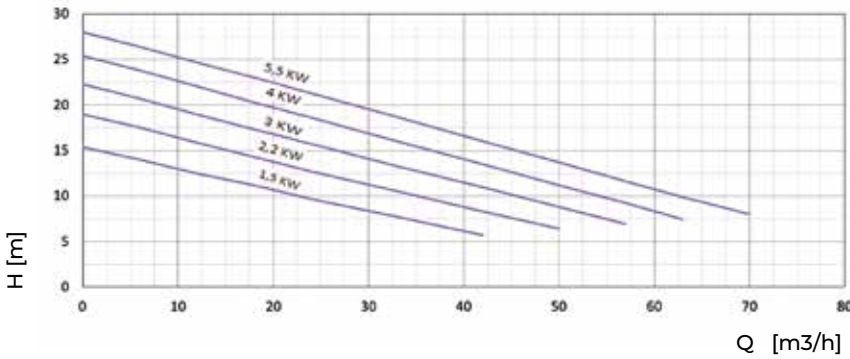
M AST 50/130
 PERFORMANS EĞRİLERİ

GİRİŞ(INPUT): 2 1/2" ÇIKIŞ(OUTPUT): 2"

2900 d/dak (l/min)

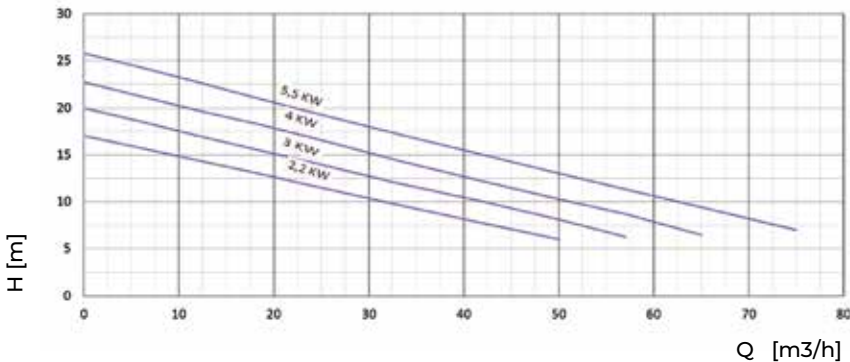

T-KST SERİSİ
T-KST SERIES
2900 d/dak (l/min)



PERFORMANS TABLOSU
PERFORMANCE TABLE

POMPA TİPİ PUMP TYPE	kw	GİRİŞ-ÇIKIŞ	m ³ /h	0	5	14	20	23	25	30	33	36
T-KST 50/110	2,2	2"-2"	H[m]	25	24	20	15	11,5	9	2,5		
	3	2"-2"		28	27	24	20	16,56	14	7	3	

T-KST 50/110
PERFORMANS EĞRİLERİ

GİRİŞ(INPUT): 2" ÇIKIŞ(OUTPUT): 2"

2900 d/dak (l/min)

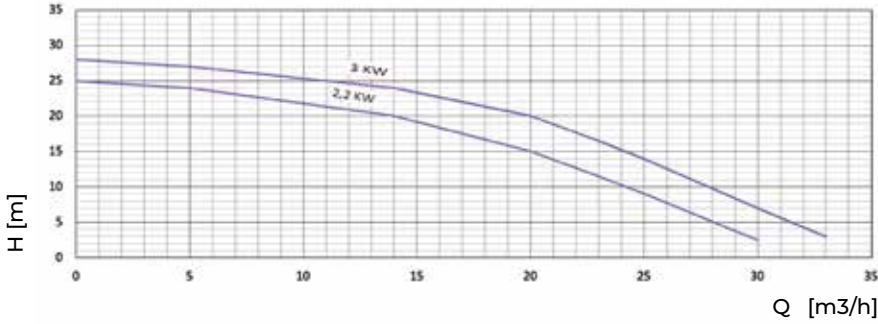

ÖZELLİKLERİ
PROPERTIES

Paslanmaz fanlı
Sıvı sıcaklığı maksimum +85 °C
Tek fazlı motorlar termal aşırı yük koruyuculu
AISI304 malzeme kaynaklı motor mili
NBR / Seramik / Grafit mekanik salmastra
Çalışma basıncı maksimum 8 bar
Bakır tel sargı
Maksimum ortalama sıcaklığı +40 °C
Maksimum emiş 9 metre

With stainless fan
Liquid temperature maximum +85 °C
Single-phase motors with thermal overload protector
AISI304 material welded motor shaft
NBR / Ceramic / Graphite mechanical seal
Working pressure maximum 8 bar
Copper wire winding
Maximum average temperature +40 °C
Max suction 9 meters

H-AST SERİSİ
 H-AST SERIES
 1450 d/dak (l/min)

PERFORMANS TABLOSU
 PERFORMANCE TABLE

POMPA TİPİ PUMP TYPE	kw	GİRİŞ-ÇIKIŞ	m ³ /h	0	6	16	20	24	31	38	43	50	57	60
H-AST 50/160	1,1	2"-2"	H[m]	8	7	5,3	4,7	4	3,1	2,4	2			
	1,5	2"-2"		9	8	6,3	5,6	5	4	3,2	2,8	2,2		
	2,2	2"-2"		10,2	9,2	7,4	6,8	6,1	5	4,2	3,7	3	2,5	
	1,5	2"-2"		12	10,8	8,8	8,1	7,4	6,3	5,3	4,7	3,9	3,3	3

H-AST
 PERFORMANS EĞRİLERİ

GİRİŞ(INPUT): 2" ÇIKIŞ(OUTPUT): 2"

1450 d/dak (l/min)

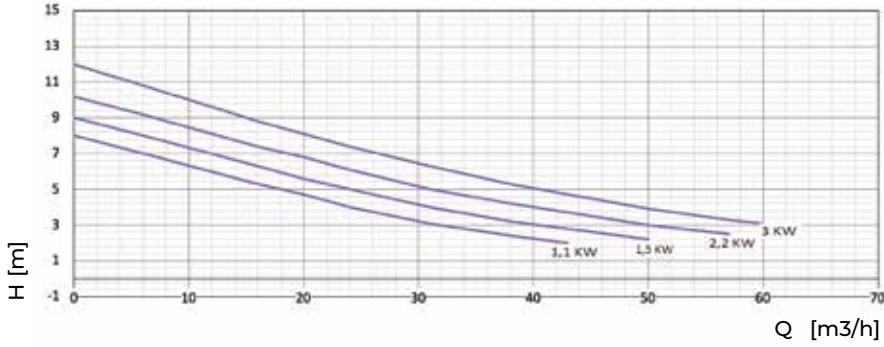
ÖZELLİKLERİ
 PROPERTIES

Çift piriç fanlı
 Sıvı sıcaklığı maksimum +85 °C
 Tek fazlı motorlar termal aşırı yük koruyuculu
 AISI304 malzeme kaynaklı motor mili
 NBR / Seramik grafit / Mekanik salmastra
 Çalışma basıncı maksimum 8 bar
 Bakır tel sargı
 Maksimum ortam sıcaklığı +40 °C
 Maksimum emiş 6-7 metre

With double brass fan
 Liquid temperature maximum +85 °C
 Single-phase motors with thermal overload protector
 AISI304 material welded motor shaft
 NBR / Ceramic graphite / Mechanical seal
 Working pressure maximum 8 bar
 Copper wire winding
 Maximum ambient temperature +40 °C
 Maximum suction 6-7 meters

Y-KST SERİSİ
Y-KST SERIES
2900 d/dak (l/min)



PERFORMANS TABLOSU
PERFORMANCE TABLE

POMPA TİPİ PUMP TYPE	kw	GİRİŞ-ÇIKIŞ	m ³ /h	0	5	14	20	23	25	30	33	36
Y-KST 40/110	1,5	2"-1,1/2"	H[m]	25	24	20	15	11,5	9	2,5		
	2,2	2"-1,1/2"		28	27	24	20	16,56	14	7	3	
	3	2"-1,1/2"		31	30	28	24,5	21,5	19	12	7,5	3

Y-KST
PERFORMANS EĞRİLERİ

GİRİŞ(INPUT): 2" ÇIKIŞ(OUTPUT): 1,1/2"

2900 d/dak (l/min)

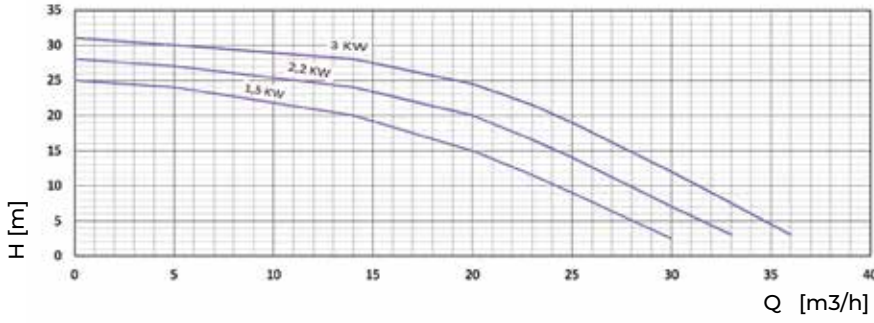

ÖZELLİKLERİ
PROPERTIES

Çift pirinç fanlı
Sıvı sıcaklığı maksimum +85 °C
Tek fazlı motorlar termal aşırı yük koruyuculu
AISI304 malzeme kaynaklı motor mili
NBR / Seramik grafit / Mekanik salmastra
Çalışma basıncı maksimum 8 bar
Bakır tel sargı
Maksimum ortam sıcaklığı +40 °C
Maksimum emiş 6-7 metre

With double brass fan
Liquid temperature maximum +85 °C
Single-phase motors with thermal overload protector
AISI304 material welded motor shaft
NBR / Ceramic graphite / Mechanical seal
Working pressure maximum 8 bar
Copper wire winding
Maximum ambient temperature +40 °C
Maximum suction 6-7 meters

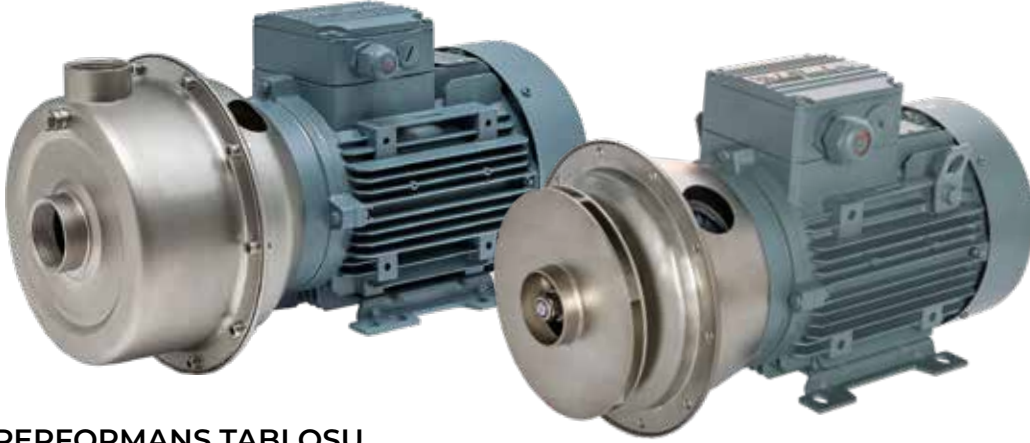

PERFORMANS TABLOSU

PERFORMANCE TABLE

POMPA TİPİ PUMP TYPE	kw	GİRİŞ-ÇIKIŞ	m ³ /h	0	3	10	15	20	25
KST 32/180	1,5	1,1/2"-1,1/4"	H[m]	32	29	23	18	13	6
	2,2	1,1/2"-1,1/4"		34	32	26	21	16	8
	3	1,1/2"-1,1/4"		36	34	28,5	24	18,5	10

KST 32/180

PERFORMANS EĞRİLERİ

GİRİŞ(INPUT): 1,1/2" ÇIKIŞ(OUTPUT): 1,1/4"

2900 d/dak (l/min)

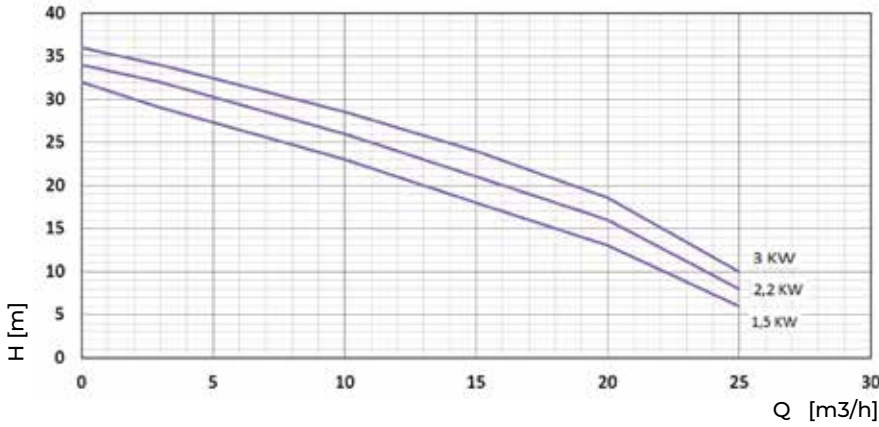

ÖZELLİKLERİ

PROPERTIES

Paslanmaz fanlı
Sıvı sıcaklığı maksimum +85 °C
Tek fazlı motorlar termal aşırı yük koruyuculu
AISI304 malzeme kaynaklı motor mili
NBR / Seramik / Grafit mekanik salmastra
Çalışma basıncı maksimum 8 bar
Bakır tel sarğı
Maksimum ortalama sıcaklığı +40 °C
Maksimum emiş 9 metre

With stainless fan
Liquid temperature maximum +85 °C
Single-phase motors with thermal overload protector
AISI304 material welded motor shaft
NBR / Ceramic / Graphite mechanical seal
Working pressure maximum 8 bar
Copper wire winding
Maximum average temperature +40 °C
Max suction 9 meters

KST 32 SERİSİ

KST 32 SERIES

1450 d/dak (l/min)



PERFORMANS TABLOSU

PERFORMANCE TABLE

POMPA TİPİ PUMP TYPE	kw	GİRİŞ-ÇIKIŞ	m ³ /h	0	5	8	12	13	14	16
KST 32/160	0,55	50-32	H[m]	10,3	10,1	9,7	8,4	8	7,7	
	0,75	50-32		11,6	11,5	11,3	10	9,7	9,4	8,3

POMPA TİPİ PUMP TYPE	kw	GİRİŞ-ÇIKIŞ	m ³ /h	0	5	8	10	12	13	14	16	18	20
KST 32/200	0,55	50-32	H[m]	10,2	9,6	9	8,5	7,8	7,3	6,8			
	0,75	50-32		13	12,2	11,7	11,3	10,7	10,2	9,7	8,6		
	1,1	50-32		16	15,3	14,6	14	13,3	12,9	12,5	11,4	10	
	1,5	50-32		19	18	17,1	16,4	15,6	15,2	14,8	13,8	12,7	11,5

POMPA TİPİ PUMP TYPE	kw	GİRİŞ-ÇIKIŞ	m ³ /h	0	5	8	10	12	14	16	18	20	23	25
KST 32-250	1,1	50-32	H[m]	14,3	14	13,5	13	12,3	11	9	6			
	1,5	50-32		19	18,9	18,7	18,5	18	17,2	16	13,7	11		
	2,2	50-32		22,5	22,4	22,2	22	21,8	21,4	20,7	19,5	18	15	
	3	50-32		25	24,5	24,3	24,2	24	23,5	23	22,3	21,3	19	17

KULLANIM ALANLARI

USAGE AREAS

Endüstriyel tip bulaşık ve çamaşır makinelerinde
Bol debili yıkama sistemlerinde
İçme suyu ve dolun tesislerinde
Isıtma ve soğutma sistemlerinde
Kapalı devre soğutma (Chiller) sistemlerinde
Boyahanelerde boya ve boyalı sıvı basımında
Gıda endüstrisinde (meşrubat, meyve suyu ve süt fabrikalarında)
Isıtma ve hava şartlandırma sistemlerinde
Glikol çözeltilerini basmada
Az aşındırıcı endüstriyel ve kimyasal sıvılarda
Biodizel tesislerde
Baca gazı arıtma sistemlerinde
Meyve ve sebze yıkama makinalarında
Çelik tencere imalatında
Kuruyemiş tuzlama işlemlerinde

Industrial type dishwashers and washing machines
In high flow washing systems
Drinking water and filling facilities
In heating and cooling systems
In closed circuit cooling (Chiller) systems
In dye and dyed liquid printing in dyehouses
In the food industry (beverage, juice and dairy factories)
Heating and air conditioning systems
Pressing glycol solutions
In less corrosive industrial and chemical liquids
Biodiesel in plants
In flue gas treatment systems
In fruit and vegetable washing machines
In the manufacture of steel pots
Nuts salting processes

KST 32/160
 PERFORMANS EĞRİLERİ

GİRİŞ(INPUT): DN50 ÇIKIŞ(OUTPUT): DN32

1450 d/dak (l/min)

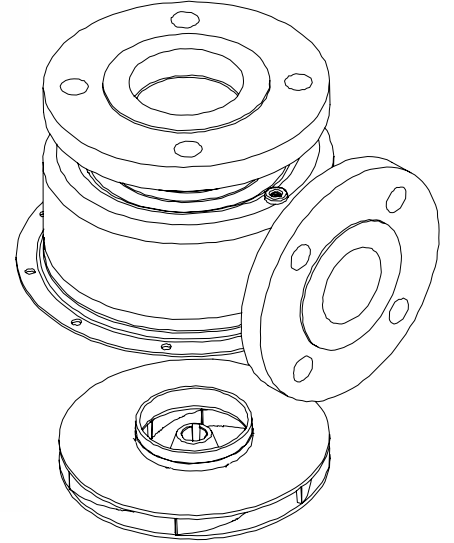
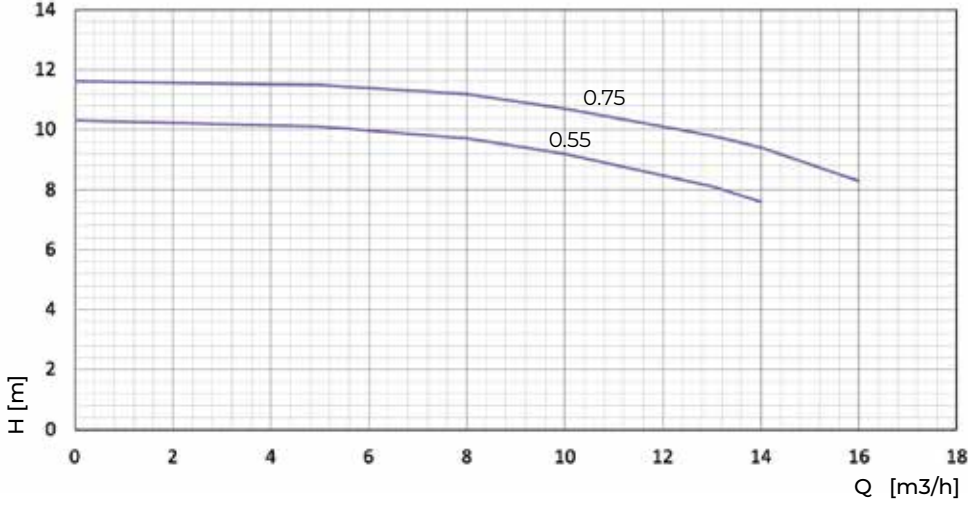
KST 32/200
 PERFORMANS EĞRİLERİ

GİRİŞ(INPUT): DN50 ÇIKIŞ(OUTPUT): DN32

1450 d/dak (l/min)

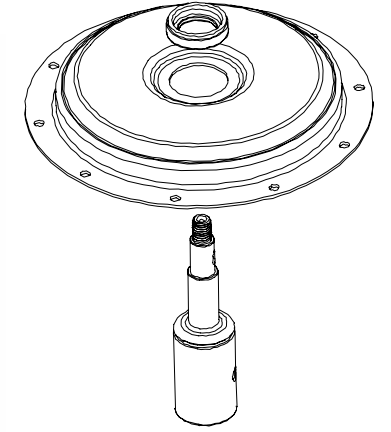
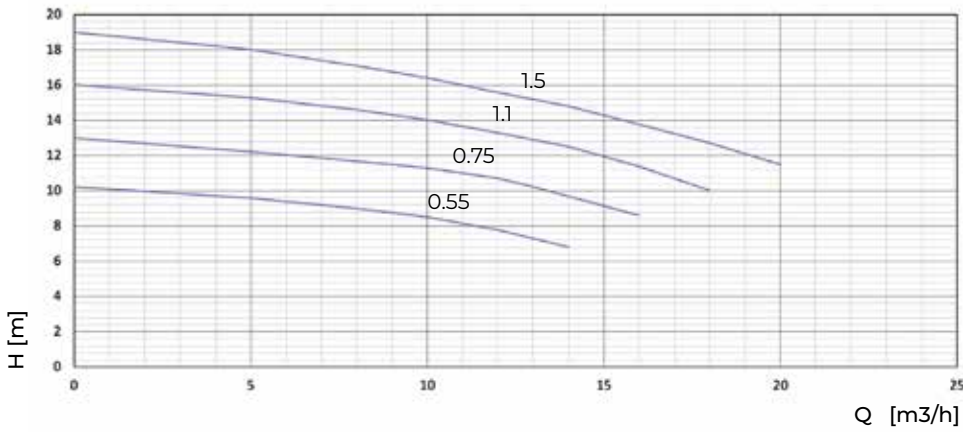

KST 32/250
 PERFORMANS EĞRİLERİ

GİRİŞ(INPUT): DN50 ÇIKIŞ(OUTPUT): DN32

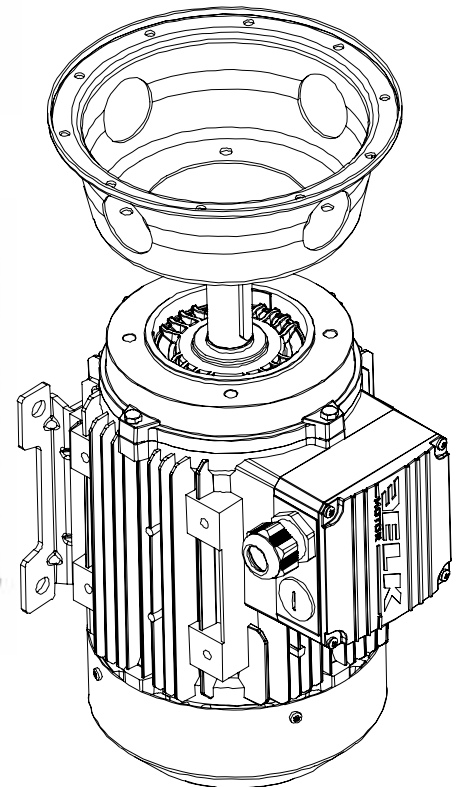
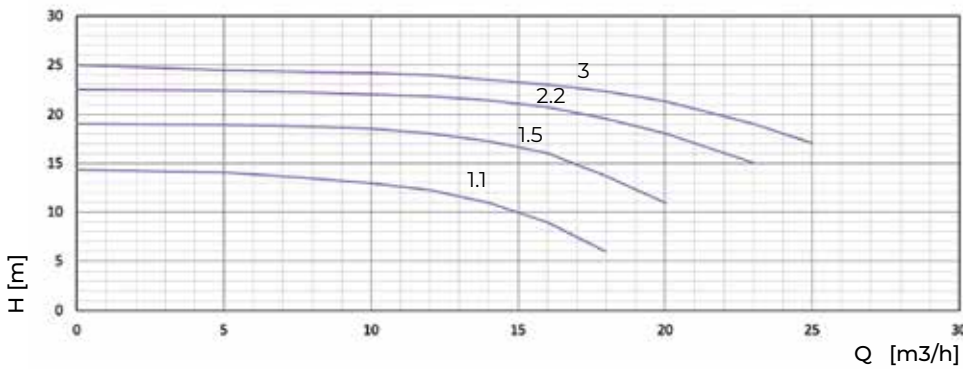
1450 d/dak (l/min)

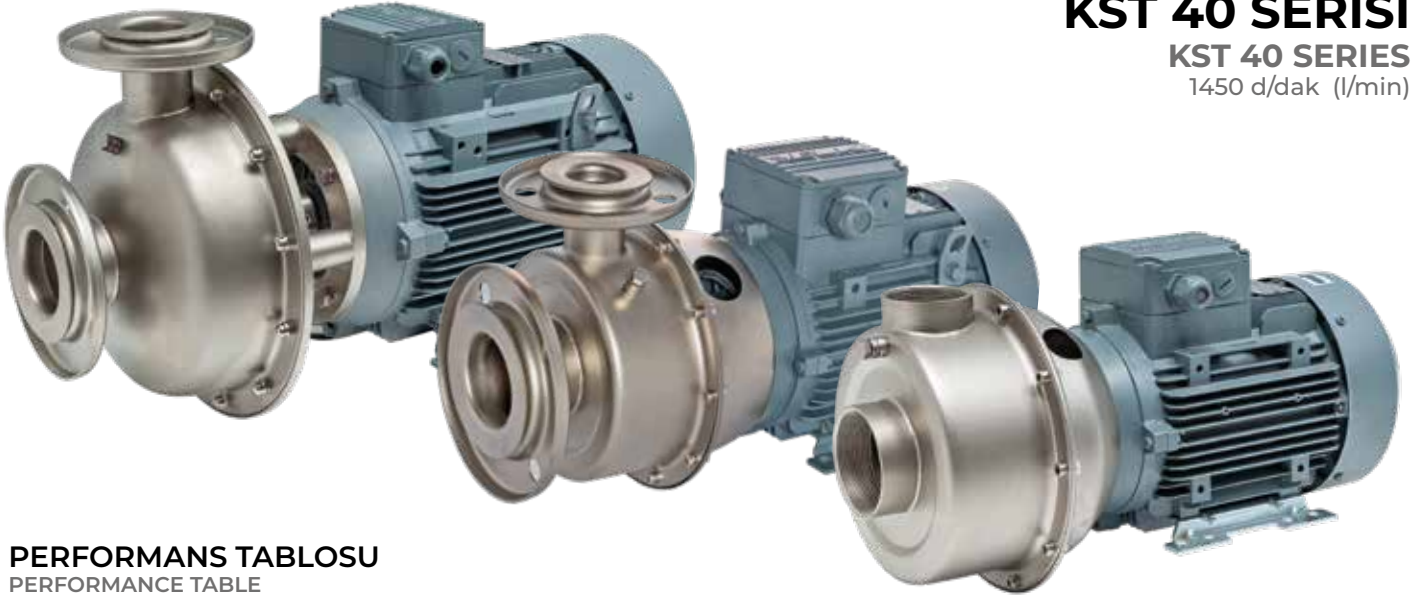

KST 40 SERİSİ
KST 40 SERIES
1450 d/dak (l/min)



PERFORMANS TABLOSU
PERFORMANCE TABLE

POMPA TİPİ PUMP TYPE	kw	GİRİŞ-ÇIKIŞ	m ³ /h	0	5	8	10	15	18	20	23	25
KST 40/160	0,55	65-40	H[m]	8,5	8,3	8	7,8	6,7	5	3,5		
	0,75	65-40		10,8	10,6	10,4	10,2	9,2	8	7	5	
	1,1	65-40		12,4	12,3	12,1	11,9	11,3	10,5	9,8	8,2	7

POMPA TİPİ PUMP TYPE	kw	GİRİŞ-ÇIKIŞ	m ³ /h	0	5	8	10	15	18	20	23	25	27
KST 40-200	0,75	65-40	H[m]	10	9,7	9,6	9,4	8,2	6,6	5,5			
	1,1	65-40		13,4	13,2	13	12,9	12	11	10	8		
	1,5	65-40		16	15,9	15,7	15,5	14,7	13,8	12,9	11,4	10	
	2,2	65-40		18	17,7	17,4	17,2	16,4	15,7	15,1	13,9	12,6	11

POMPA TİPİ PUMP TYPE	kw	GİRİŞ-ÇIKIŞ	m ³ /h	0	5	8	10	15	18	23	27	29	30
KST 40/250	1,1	65-40	H[m]	12,8	12,2	12,1	11,5	11	10,2	8			
	1,5	65-40		15,3	15	14,9	12,5	11,8	12	12,5	11		
	2,2	65-40		18,9	18,5	18,3	18	17,5	16,8	15	13	12,6	
	3	65-40		22,2	22	21,8	21,5	21	20,4	19	17,2	16,3	16

POMPA TİPİ PUMP TYPE	kw	GİRİŞ-ÇIKIŞ	m ³ /h	0	5	8	10	15	18	20	23	25	27	29	30
KST 40/315	2,2	65-40	H[m]	20	19,5	19,2	19	17,5	16	15					
	3	65-40		25	24,5	24,2	24	23	22	20,5	17				
	4	65-40		30	29,7	29,4	29,2	28,8	28	26,7	23,5	21	18		
	5,5	65-40		36	35,6	35,4	35,2	35	34,2	33	30,3	28	25,5	22	20

KULLANIM ALANLARI
USAGE AREAS

Endüstriyel tip bulaşık ve çamaşır makinelerinde
Bol debili yıkama sistemlerinde
İçme suyu ve dolun tesislerinde
Isıtma ve soğutma sistemlerinde
Kapalı devre soğutma (Chiller) sistemlerinde
Boyanelerde boya ve boyalı sıvı basımında
Gıda endüstrisinde (meşrubat, meyve suyu ve süt fabrikalarında)
Isıtma ve hava şartlandırma sistemlerinde
Glikol çözeltilerini basmada
Az aşındırıcı endüstriyel ve kimyasal sıvılarda
Biodizel tesislerde
Baca gazı arıtma sistemlerinde
Meyve ve sebze yıkama makinalarında
Çelik tencere imalatında
Kuruyemiş tuzlama işlemlerinde

Industrial type dishwashers and washing machines
In high flow washing systems
Drinking water and filling facilities
In heating and cooling systems
In closed circuit cooling (Chiller) systems
In dye and dyed liquid printing in dyehouses
In the food industry (beverage, juice and dairy factories)
Heating and air conditioning systems
Pressing glycol solutions
In less corrosive industrial and chemical liquids
Biodiesel in plants
In flue gas treatment systems
In fruit and vegetable washing machines
In the manufacture of steel pots
Nuts salting processes

KST 40/160
 PERFORMANS EĞRİLERİ

GİRİŞ(INPUT): DN65 ÇIKIŞ(OUTPUT): DN40

1450 d/dak (l/min)

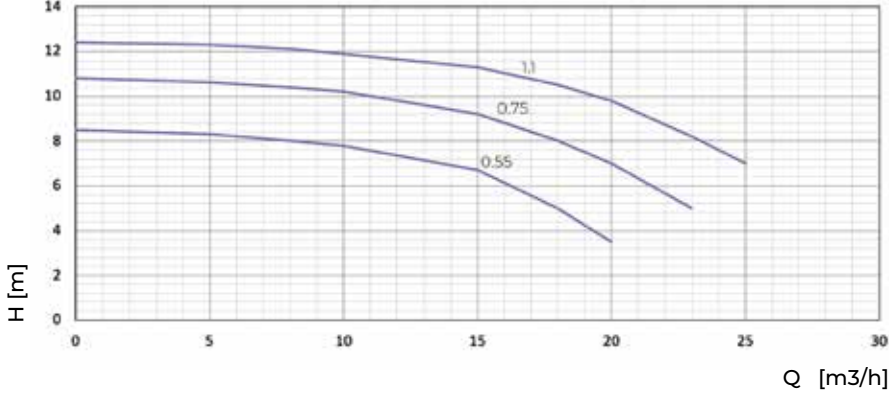
KST 40/200
 PERFORMANS EĞRİLERİ

GİRİŞ(INPUT): DN65 ÇIKIŞ(OUTPUT): DN40

1450 d/dak (l/min)

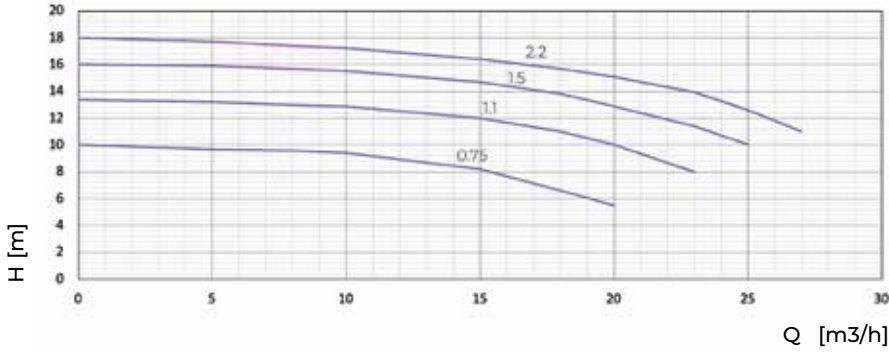
KST 40/250
 PERFORMANS EĞRİLERİ

GİRİŞ(INPUT): DN65 ÇIKIŞ(OUTPUT): DN40

1450 d/dak (l/min)

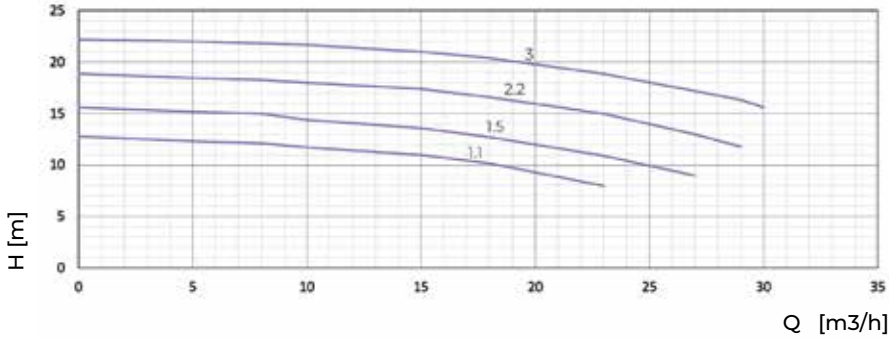
KST 40/315
 PERFORMANS EĞRİLERİ

GİRİŞ(INPUT): DN65 ÇIKIŞ(OUTPUT): DN40

1450 d/dak (l/min)

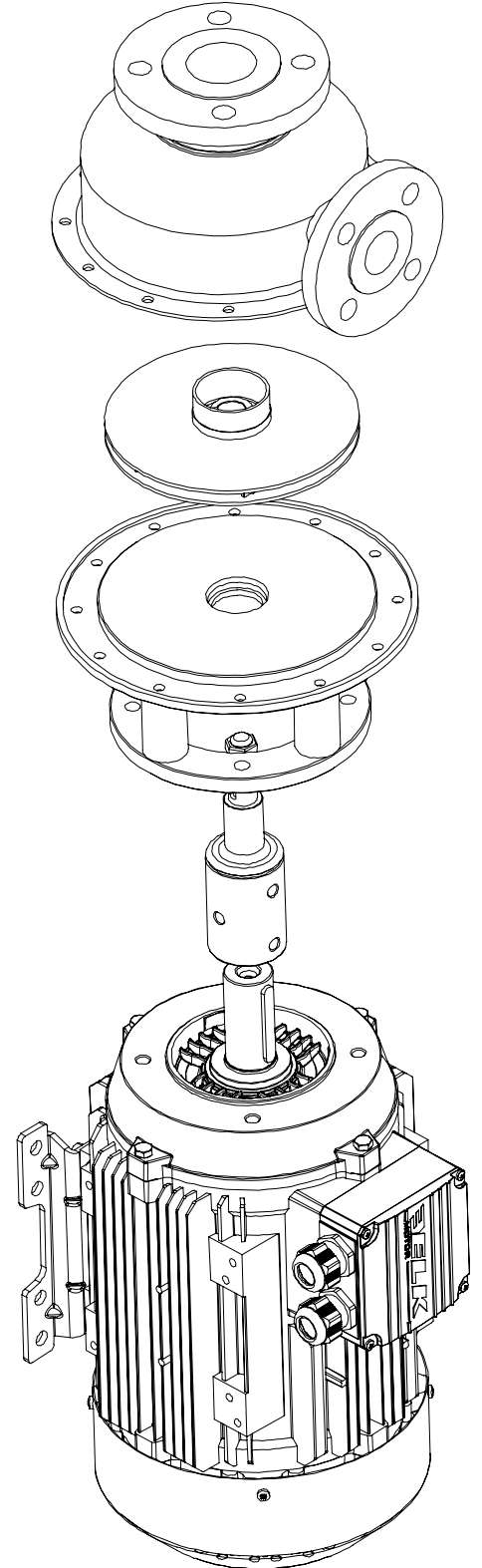
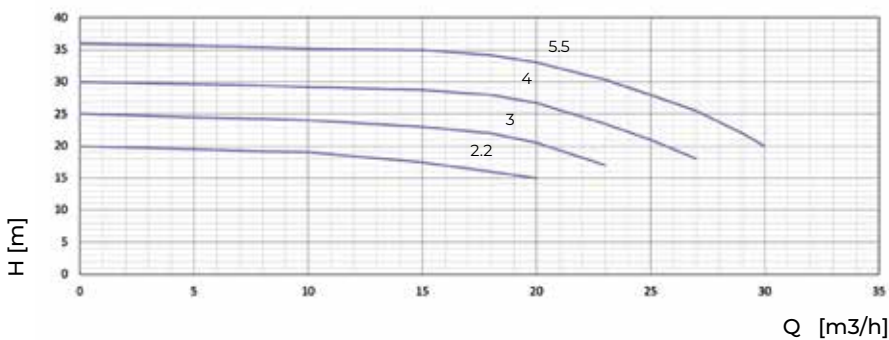

KST 50 SERİSİ

KST 50 SERIES

1450 d/dak (l/min)



PERFORMANS TABLOSU

PERFORMANCE TABLE

POMPA TİPİ PUMP TYPE	kw	GİRİŞ-ÇIKIŞ	m ³ /h	0	14	20	24	28	30						
KST 50/125	0,55	65-50	H[m]	6	5,5	4,8	4	3							
	0,75	65-50		7,5	7	6,2	5,6	4,6	4						
POMPA TİPİ PUMP TYPE	kw	GİRİŞ-ÇIKIŞ	m ³ /h	0	14	20	24	28	30	35					
KST 50/160	0,75	65-50	H[m]	8,4	7,8	7,2	6,5								
	1,1	65-50		10	9,7	9,2	8,7	8	7,6						
	1,5	65-50		11,5	11,2	10,8	10,3	9,6	9,2	8					
POMPA TİPİ PUMP TYPE	kw	GİRİŞ-ÇIKIŞ	m ³ /h	0	14	20	24	28	30	35	40	46	50		
KST 50/200	1,1	65-50	H[m]	10,5	10	9,5	8,9	7,8	7,2						
	1,5	65-50		12,5	12,2	11,8	11,3	10,5	10,2	9,2					
	2,2	65-50		15	14,5	14	13,5	13	12,8	12	11	9,5			
	3	65-50		16,5	16	15,6	15,2	14,7	14,4	13,6	12,7	11,2	10		
POMPA TİPİ PUMP TYPE	kw	GİRİŞ-ÇIKIŞ	m ³ /h	0	14	20	24	28	30	35	40	46	50	55	60
KST 50/250	2,2	65-50	H[m]	15	14,6	14	13,6	13,1	12,8	11,8	10,7	9,2			
	3	65-50		19	18,4	18	17,5	16,9	16,5	15,7	14,8	13,4	12,2		
	3	65-50		21	20,5	20	19,6	19,1	18,8	18	17,2	15,9	14,8	13	
	5,5	65-50		23	22,7	22,5	22,1	21,7	21,4	20,8	20,2	19	18,2	16,8	15
POMPA TİPİ PUMP TYPE	kw	GİRİŞ-ÇIKIŞ	m ³ /h	0	14	20	24	28	30	35	40	46	50	55	60
KST 50/315	4	65-50	H[m]	25	24	23,5	22,9	22,4	22	21	20				
	5,5	65-50		30	29	28	27,5	26,9	26,5	25,5	24	22			
	7,5	65-50		36	35	34	33,5	33	32,6	31,6	30,4	28,6	27		
	11	65-50		44	43	42	41,3	40,6	40,3	39	38	36,4	35,3	33,7	32

KULLANIM ALANLARI

USAGE AREAS

Endüstriyel tip bulaşık ve çamaşır makinelerinde
Bol debili yıkama sistemlerinde
İçme suyu ve dolum tesislerinde
Isıtma ve soğutma sistemlerinde
Kapalı devre soğutma (Chiller) sistemlerinde
Boyanelerde boya ve boyalı sıvı basımında
Gıda endüstrisinde (meşrubat, meyve suyu ve süt fabrikalarında)
Isıtma ve hava şartlandırma sistemlerinde
Glikol çözeltilerini basmada
Az aşındırıcı endüstriyel ve kimyasal sıvılarda
Biodizel tesislerde
Baca gazı arıtma sistemlerinde
Meyve ve sebze yıkama makinalarında
Çelik tencere imalatında
Kuruyemiş tuzlama işlemlerinde

Industrial type dishwashers and washing machines
In high flow washing systems
Drinking water and filling facilities
In heating and cooling systems
In closed circuit cooling (Chiller) systems
In dye and dyed liquid printing in dyehouses
In the food industry (beverage, juice and dairy factories)
Heating and air conditioning systems
Pressing glycol solutions
In less corrosive industrial and chemical liquids
Biodiesel in plants
In flue gas treatment systems
In fruit and vegetable washing machines
In the manufacture of steel pots
Nuts salting processes

KST 50/125 PERFORMANS EĞRİLERİ

GİRİŞ(INPUT): DN65 ÇIKIŞ(OUTPUT): DN50
1450 d/dak (l/min)

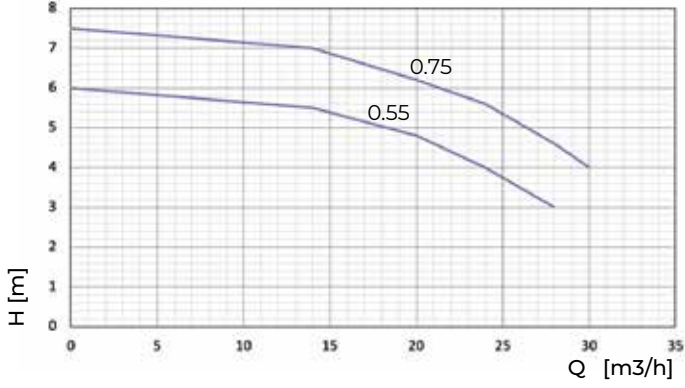

KST 50/160 PERFORMANS EĞRİLERİ

GİRİŞ(INPUT): DN65 ÇIKIŞ(OUTPUT): DN50
1450 d/dak (l/min)

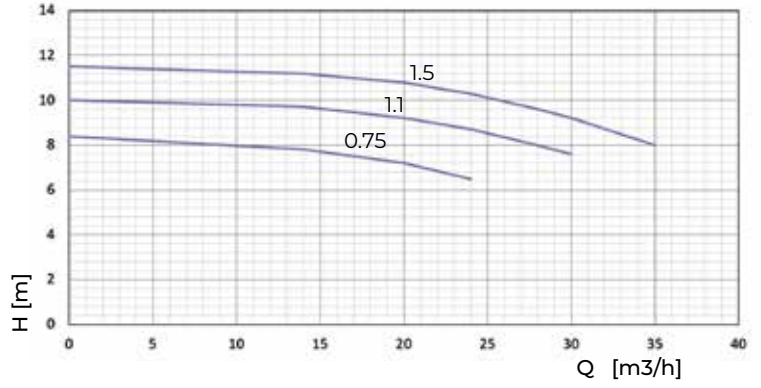

KST 50/200 PERFORMANS EĞRİLERİ

GİRİŞ(INPUT): DN65 ÇIKIŞ(OUTPUT): DN50
1450 d/dak (l/min)

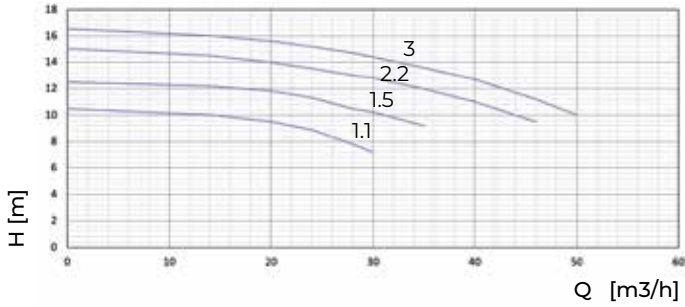

KST 50/250 PERFORMANS EĞRİLERİ

GİRİŞ(INPUT): DN65 ÇIKIŞ(OUTPUT): DN50
1450 d/dak (l/min)

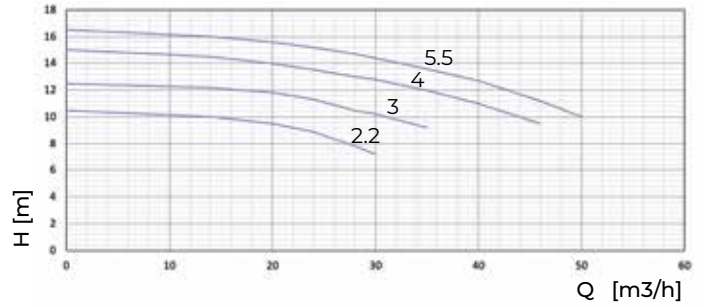

KST 50/315 PERFORMANS EĞRİLERİ

GİRİŞ(INPUT): DN65 ÇIKIŞ(OUTPUT): DN50
1450 d/dak (l/min)

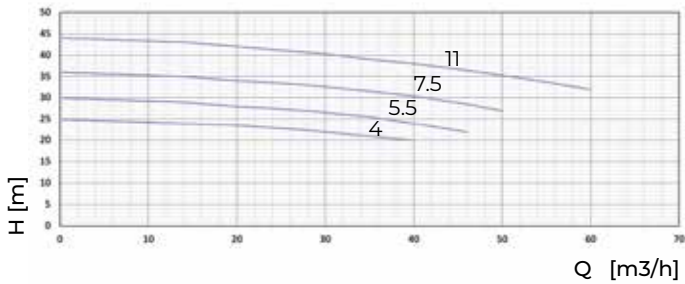

KST 65 SERİSİ

KST 65 SERIES

1450 d/dak (l/min)

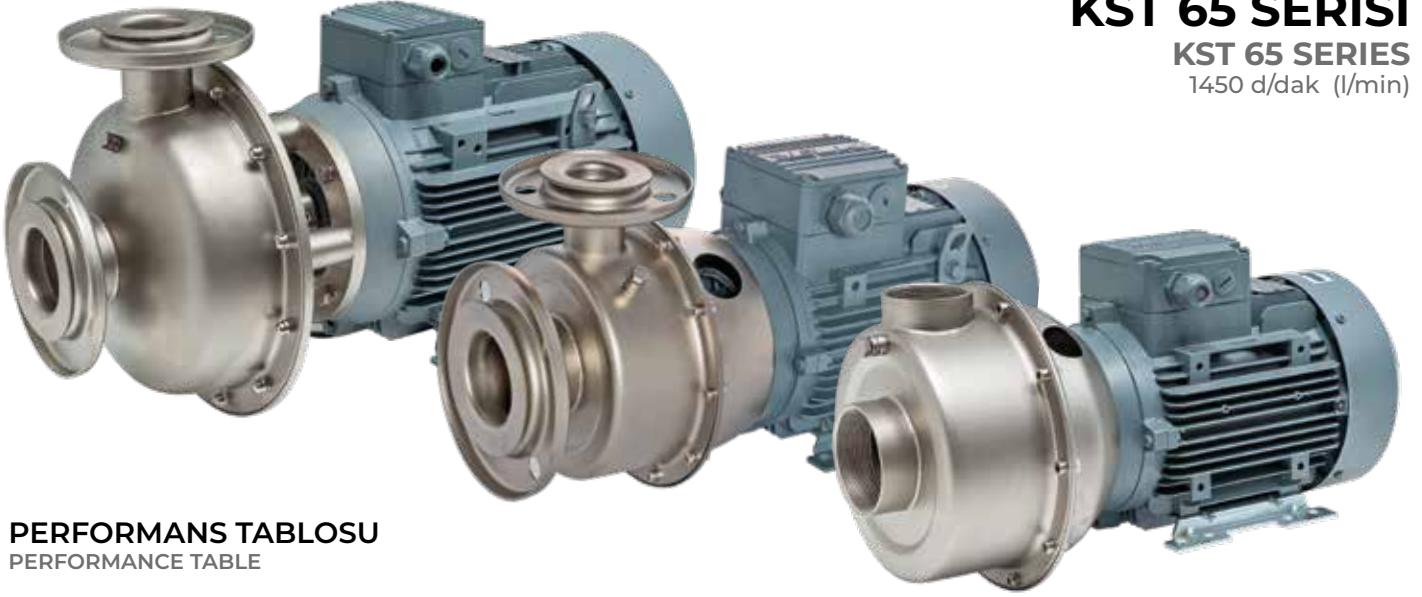

PERFORMANS TABLOSU

PERFORMANCE TABLE

POMPA TİPİ PUMP TYPE	kw	GİRİŞ-ÇIKIŞ	m ³ /h	0	15	26	35	43	55	62	68
KST 65/160	1,1	80-65	H[m]	8,5	7,8	7,1	6,3	5,5	4		
	1,5	80-65		10	9,2	8,5	7,7	6,9	5,5	4,5	
	2,2	80-65		11,8	11	10,3	9,5	8,7	7,5	6,7	5,9

POMPA TİPİ PUMP TYPE	kw	GİRİŞ-ÇIKIŞ	m ³ /h	0	15	26	35	43	55	62	70
KST 65/200	1,5	80-65	H[m]	10	9,5	9	8,4	7,8			
	2,2	80-65		12	11,8	11,5	11	10,4	9,3		
	3	80-65		14	13,9	13,8	13,4	12,9	11,7	10,7	
	4	80-65		16	15,8	15,7	15,5	15	13,9	13	11,8

POMPA TİPİ PUMP TYPE	kw	GİRİŞ-ÇIKIŞ	m ³ /h	0	15	26	35	43	55	62	70
KST 65/250	3	80-65	H[m]	16,3	16	15,5	14,7	13,8	11,8	10,5	
	4	80-65		19,8	19,7	19,3	18,5	17,7	16	14,7	
	5,5	80-65		23	22,6	22,4	21,8	21	19,5	18,4	17
	7,5	80-65		25,3	25	24,4	23,7	23	21,5	20,5	19,2

POMPA TİPİ PUMP TYPE	kw	GİRİŞ-ÇIKIŞ	m ³ /h	0	15	26	35	43	55	62	70	80	95	110
KST 65/315	5,5	80-65	H[m]	23,5	23	22,5	22	21,3	20	18,6	16,7			
	7,5	80-65		30	29,6	29	28,5	27,7	26,5	25,4	23,8	21		
	11	80-65		35,2	35	34,7	34,3	33,8	32,6	31,7	30,5	28,4	24	
	15	80-65		38,5	38,3	38,2	38	37,6	36,8	36,1	35,1	33,5	30	25

KULLANIM ALANLARI

USAGE AREAS

Endüstriyel tip bulaşık ve çamaşır makinelerinde
Bol debili yıkama sistemlerinde
İçme suyu ve dolum tesislerinde
Isıtma ve soğutma sistemlerinde
Kapalı devre soğutma (Chiller) sistemlerinde
Boyanelerde boya ve boyalı sıvı basımında
Gıda endüstrisinde (meşrubat, meyve suyu ve süt fabrikalarında)
Isıtma ve hava şartlandırma sistemlerinde
Glikol çözeltilerini basmada
Az aşındırıcı endüstriyel ve kimyasal sıvılarda
Biodizel tesislerde
Baca gazı arıtma sistemlerinde
Meyve ve sebze yıkama makinalarında
Çelik tencere imalatında
Kuruyemiş tuzlama işlemlerinde

Industrial type dishwashers and washing machines
In high flow washing systems
Drinking water and filling facilities
In heating and cooling systems
In closed circuit cooling (Chiller) systems
In dye and dyed liquid printing in dyehouses
In the food industry (beverage, juice and dairy factories)
Heating and air conditioning systems
Pressing glycol solutions
In less corrosive industrial and chemical liquids
Biodiesel in plants
In flue gas treatment systems
In fruit and vegetable washing machines
In the manufacture of steel pots
Nuts salting processes

KST 65/160

PERFORMANS EĞRİLERİ

GİRİŞ (INPUT): DN80 ÇIKIŞ (OUTPUT): DN65

1450 d/dak (l/min)

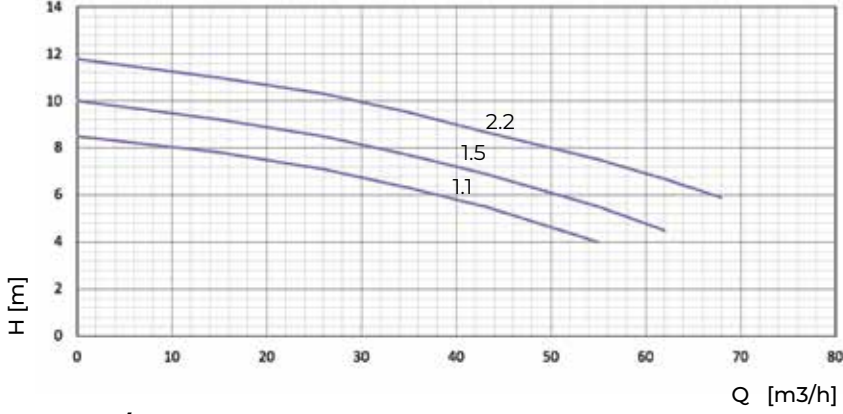

KST 65/200

PERFORMANS EĞRİLERİ

GİRİŞ (INPUT): DN80 ÇIKIŞ (OUTPUT): DN65

1450 d/dak (l/min)

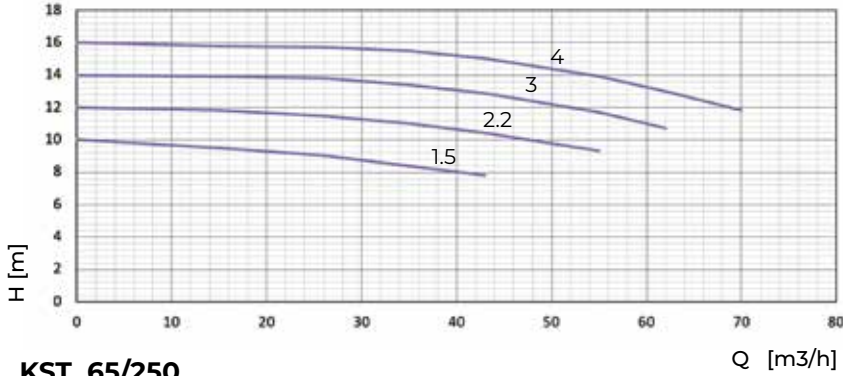

KST 65/250

PERFORMANS EĞRİLERİ

GİRİŞ (INPUT): DN80 ÇIKIŞ (OUTPUT): DN65

1450 d/dak (l/min)

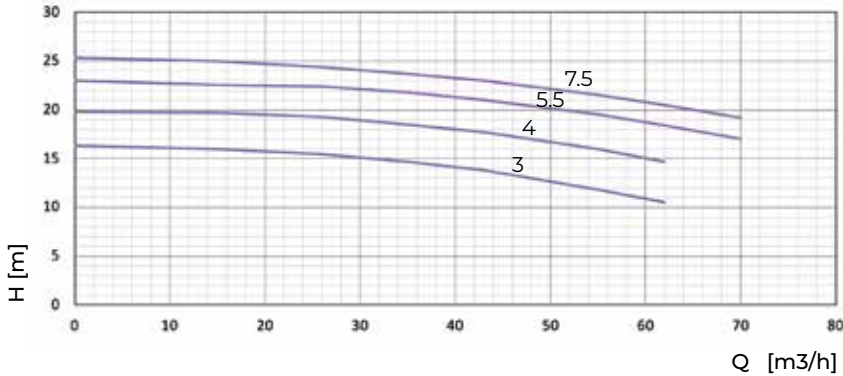

KST 65/315

PERFORMANS EĞRİLERİ

GİRİŞ (INPUT): DN80 ÇIKIŞ (OUTPUT): DN65

1450 d/dak (l/min)

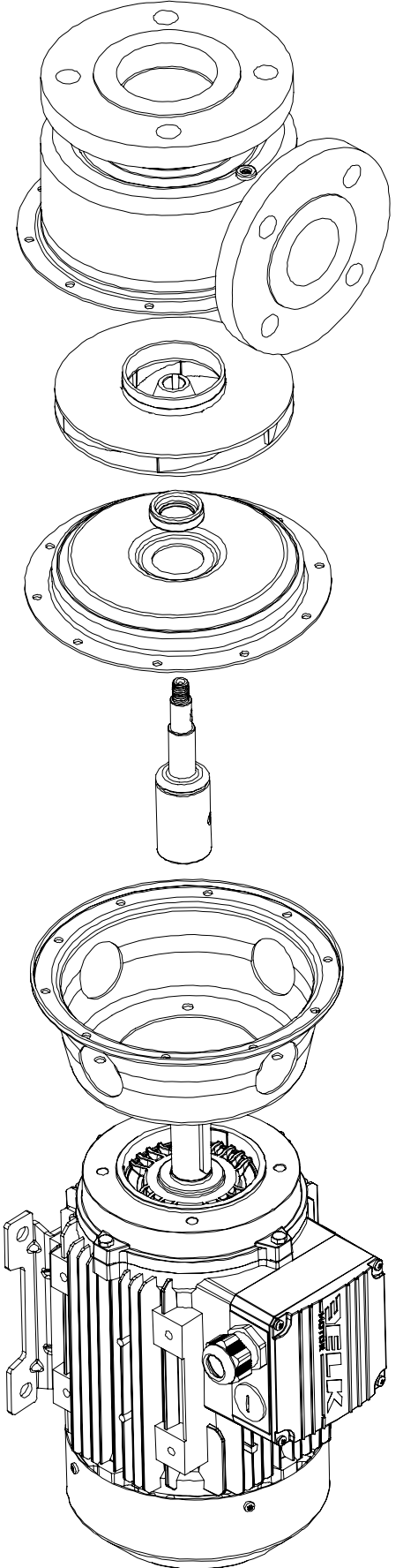
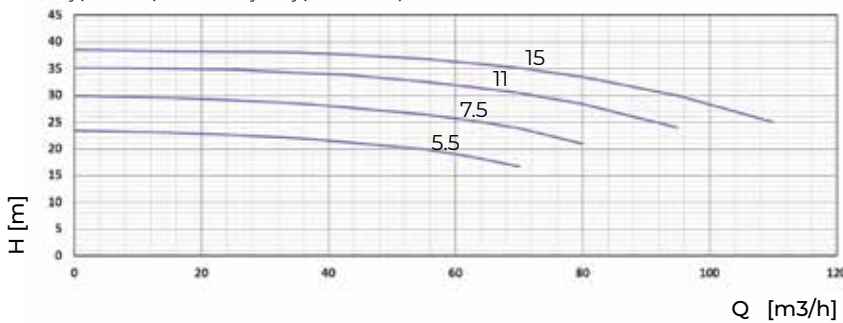

KST 80 SERİSİ

KST 80 SERIES

1450 d/dak (l/min)

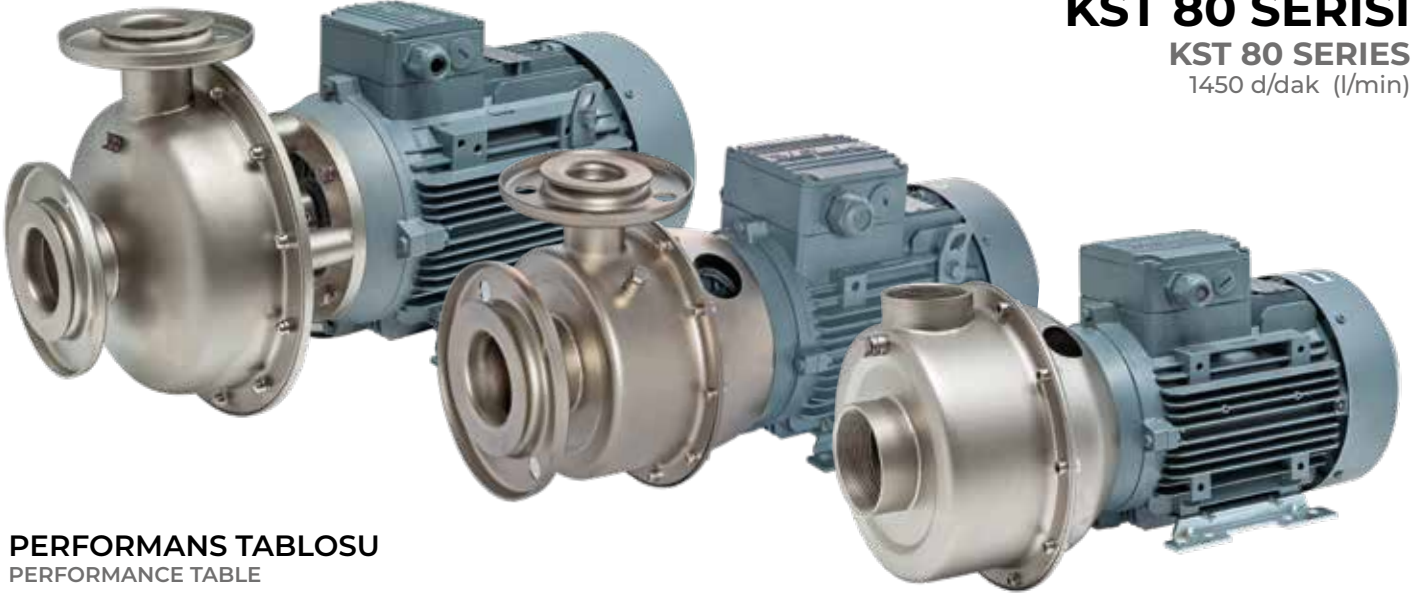

PERFORMANS TABLOSU

PERFORMANCE TABLE

POMPA TİPİ PUMP TYPE	kw	GİRİŞ-ÇIKIŞ	m ³ /h	0	20	30	40	60	80	90
KST 80/160	1,5	100-80	H[m]	9	8,7	8,2	7,6	5,8		
	2,2	100-80		11	10,7	10,4	9,9	8,2	5,3	
	3	100-80		12,5	12,2	11,9	11,5	10,2	7,8	6

POMPA TİPİ PUMP TYPE	kw	GİRİŞ-ÇIKIŞ	m ³ /h	0	20	30	40	60	80	90	100	120
KST 80/200	3	100-80	H[m]	11,3	11,1	11	10,8	10,4	9,2	8,3		
	4	100-80		13,2	13,1	13	12,9	12,5	11,6	10,8	10	
	5,5	100-80		15,1	15	14,9	14,8	14,6	14	13,5	12,8	11,3

POMPA TİPİ PUMP TYPE	kw	GİRİŞ-ÇIKIŞ	m ³ /h	0	20	30	40	60	80	90	100	120
KST 80/250	4	100-80	H[m]	15,8	15,7	15,7	15,4	14	11			
	5,5	100-80		18	17,9	17,9	17,7	16,8	14,8	13		
	7,5	100-80		21,3	21,2	21,2	21,1	20,4	19,3	18	16,2	
	11	100-80		25	24,9	24,9	24,8	24,7	24	23,5	22,5	20

POMPA TİPİ PUMP TYPE	kw	GİRİŞ-ÇIKIŞ	m ³ /h	0	30	40	60	80	90	100	120	140	160	170
KST 80/315	7,5	100-80	H[m]	24	23,6	23,2	22	20,1	19	17,4	13			
	11	100-80		30,2	29,8	29,4	28,4	27	26	24,8	21,6	17,5		
	15	100-80		35	34,8	34,6	33,8	32,6	31,8	30,9	28	24,9	20,2	
	18,5	100-80		38,2	38,1	38	37,5	36,4	35,8	35	32,7	29,6	25,7	23

KULLANIM ALANLARI

USAGE AREAS

Endüstriyel tip bulaşık ve çamaşır makinelerinde
Bol debili yıkama sistemlerinde
İçme suyu ve dolun tesislerinde
Isıtma ve soğutma sistemlerinde
Kapalı devre soğutma (Chiller) sistemlerinde
Boyahanelerde boya ve boyalı sıvı basımında
Gıda endüstrisinde (meşrubat, meyve suyu ve süt fabrikalarında)
Isıtma ve hava şartlandırma sistemlerinde
Glikol çözeltilerini basmada
Az aşındırıcı endüstriyel ve kimyasal sıvılarda
Biodizel tesislerde
Baca gazı arıtma sistemlerinde
Meyve ve sebze yıkama makinalarında
Çelik tencere imalatında
Kuruyemiş tuzlama işlemlerinde

Industrial type dishwashers and washing machines
In high flow washing systems
Drinking water and filling facilities
In heating and cooling systems
In closed circuit cooling (Chiller) systems
In dye and dyed liquid printing in dyehouses
In the food industry (beverage, juice and dairy factories)
Heating and air conditioning systems
Pressing glycol solutions
In less corrosive industrial and chemical liquids
Biodiesel in plants
In flue gas treatment systems
In fruit and vegetable washing machines
In the manufacture of steel pots
Nuts salting processes

KST 80/160
 PERFORMANS EĞRİLERİ

GİRİŞ(INPUT): DN100 ÇIKIŞ(OUTPUT): DN80 1450 d/dak (l/min)

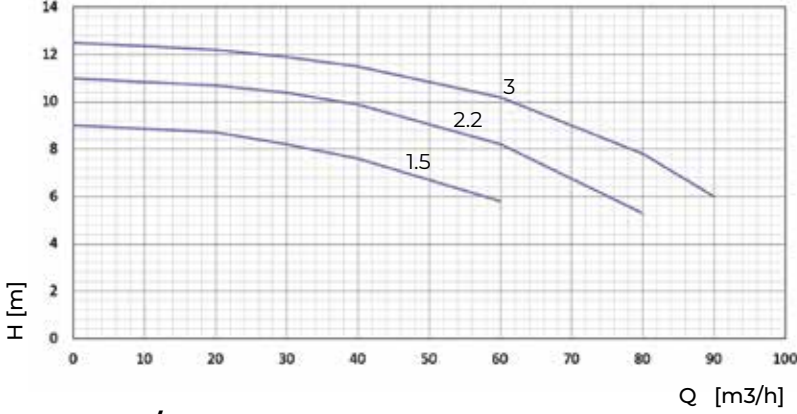
KST 80/200
 PERFORMANS EĞRİLERİ

GİRİŞ(INPUT): DN100 ÇIKIŞ(OUTPUT): DN80 1450 d/dak (l/min)

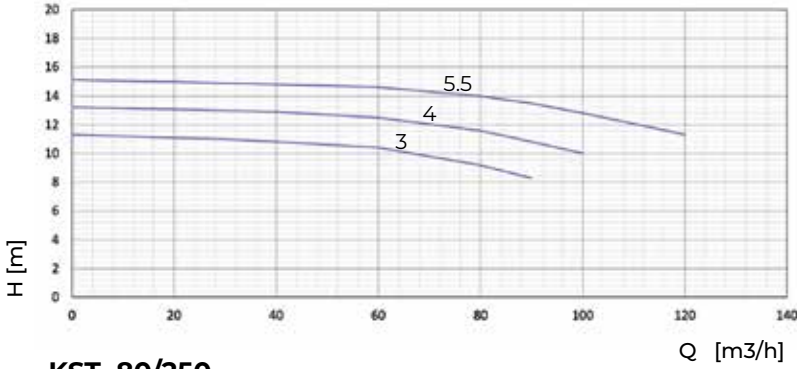
KST 80/250
 PERFORMANS EĞRİLERİ

GİRİŞ(INPUT): DN100 ÇIKIŞ(OUTPUT): DN80 1450 d/dak (l/min)

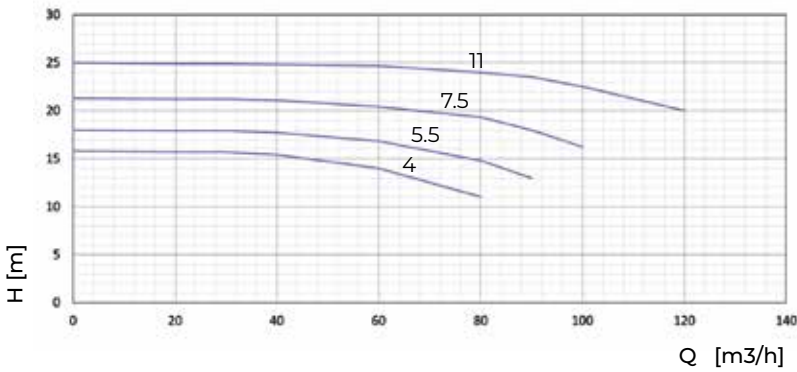
KST 80/315
 PERFORMANS EĞRİLERİ

GİRİŞ(INPUT): DN100 ÇIKIŞ(OUTPUT): DN80 1450 d/dak (l/min)

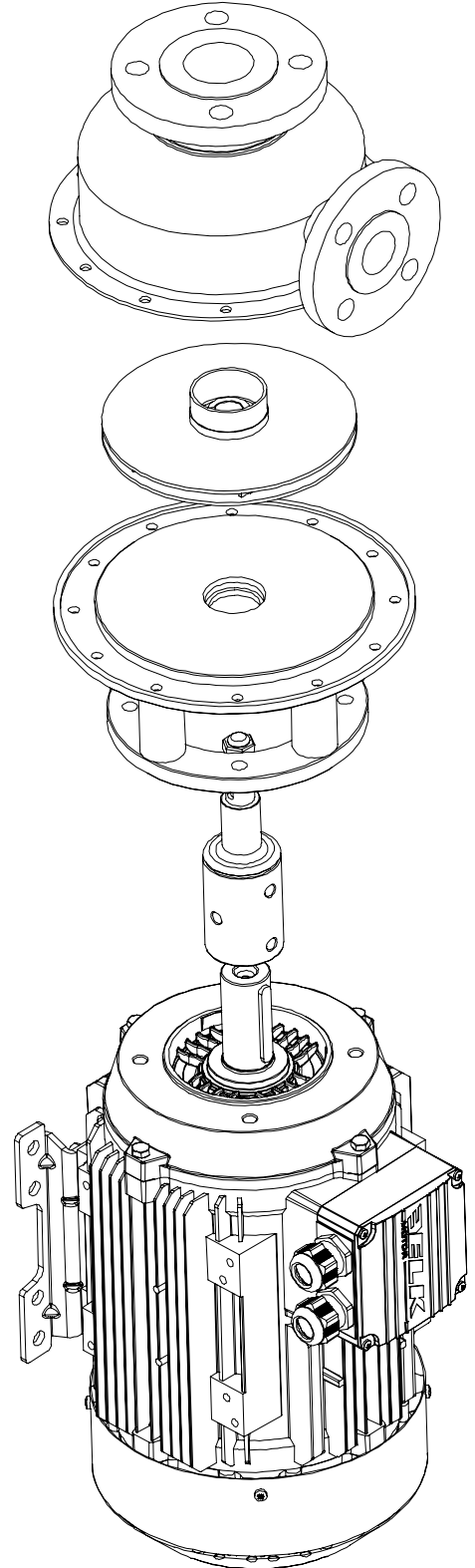
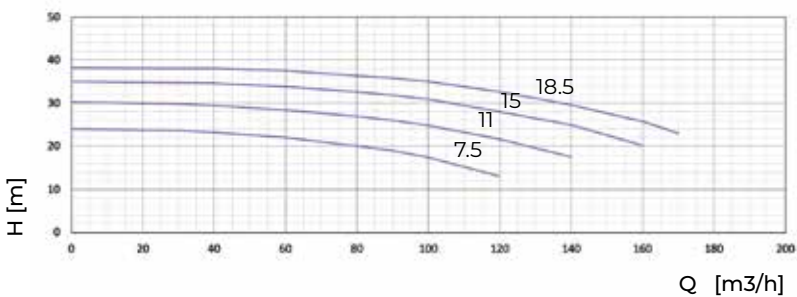

KST 100 SERİSİ

KST 100 SERIES

1450 d/dak (l/min)

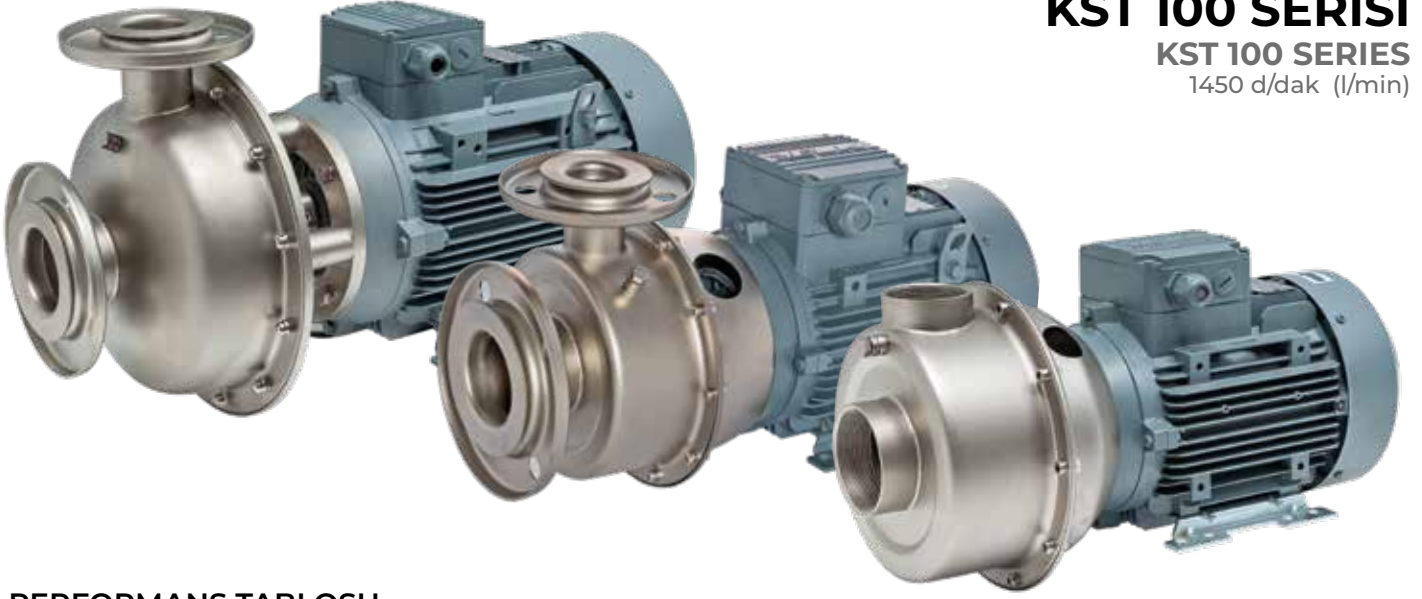

PERFORMANS TABLOSU

PERFORMANCE TABLE

POMPA TİPİ PUMP TYPE	kw	GİRİŞ-ÇIKIŞ	m ³ /h	0	50	60	80	90	100	130	150	160	180
KST 100/200	3	125-100	H[m]	10	9,2	9	8,4	8	7,5				
	4	125-100		12	11,5	11,3	10,8	10,4	9,9	8			
	5,5	125-100		14	13,5	13,4	12,9	12,5	12,1	10,5	9,1	8,3	
	7,5	125-100		15	14,7	14,6	14,2	14	13,7	12,3	10,9	10,2	8,5

POMPA TİPİ PUMP TYPE	kw	GİRİŞ-ÇIKIŞ	m ³ /h	0	50	60	80	90	100	130	150	160	180	200
KST 100/250	5,5	125-100	H[m]	16	15,3	15	14	13,4	12,5	8,8				
	7,5	125-100		18,5	18	17,7	17	16,4	15,8	12,9	10			
	11	125-100		22,5	22	21,7	21	20,5	20	17,5	15,5	14,2	11,2	
	15	125-100		24,6	24,4	24,2	23,7	23,4	23	21,3	19,8	18,8	16,2	13

POMPA TİPİ PUMP TYPE	kw	GİRİŞ-ÇIKIŞ	m ³ /h	0	50	60	80	90	100	130	150	160	180	200	220
KST 100/315	11	125-100	H[m]	23	22,8	22,7	22,4	22,2	21,8	19,8	18	16,8			
	15	125-100		27	26,9	26,8	26,4	26	25,6	23,9	22	21	18,5		
	18,5	125-100		31,2	31	30,9	30,7	30,6	30,3	29,2	28	27,3	25,5	23,5	
	22	125-100		34	33,8	33,6	33	32,8	32,4	31,5	30,5	30	28,5	26,5	24
	30	125-100		37	36,6	36,5	36,1	35,8	35,5	34,2	33	32,3	30,8	29	27

KULLANIM ALANLARI

USAGE AREAS

Endüstriyel tip bulaşık ve çamaşır makinelerinde
Bol debili yıkama sistemlerinde
İçme suyu ve dolun tesislerinde
Isıtma ve soğutma sistemlerinde
Kapalı devre soğutma (Chiller) sistemlerinde
Boyahanelerde boya ve boyalı sıvı basımında
Gıda endüstrisinde (meşrubat, meyve suyu ve süt fabrikalarında)
Isıtma ve hava şartlandırma sistemlerinde
Glikol çözeltilerini basmada
Az aşındırıcı endüstriyel ve kimyasal sıvılarda
Biodizel tesislerde
Baca gazı arıtma sistemlerinde
Meyve ve sebze yıkama makinalarında
Çelik tencere imalatında
Kuruyemiş tuzlama işlemlerinde

Industrial type dishwashers and washing machines
In high flow washing systems
Drinking water and filling facilities
In heating and cooling systems
In closed circuit cooling (Chiller) systems
In dye and dyed liquid printing in dyehouses
In the food industry (beverage, juice and dairy factories)
Heating and air conditioning systems
Pressing glycol solutions
In less corrosive industrial and chemical liquids
Biodiesel in plants
In flue gas treatment systems
In fruit and vegetable washing machines
In the manufacture of steel pots
Nuts salting processes

KST 100/200
 PERFORMANS EĞRİLERİ

GİRİŞ(INPUT): DN125 ÇIKIŞ(OUTPUT): DN100 1450 d/dak (l/min)

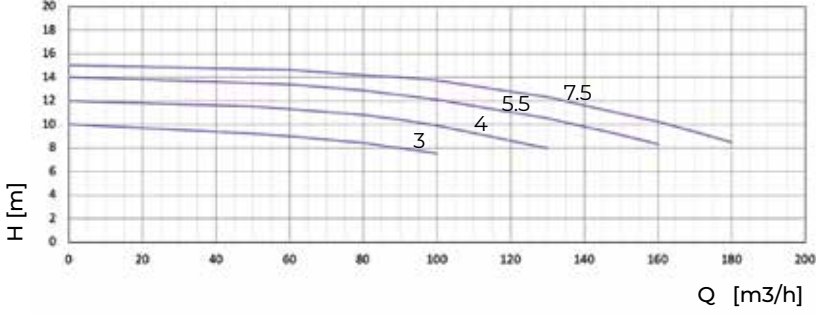
KST 100/250
 PERFORMANS EĞRİLERİ

GİRİŞ(INPUT): DN125 ÇIKIŞ(OUTPUT): DN100 1450 d/dak (l/min)

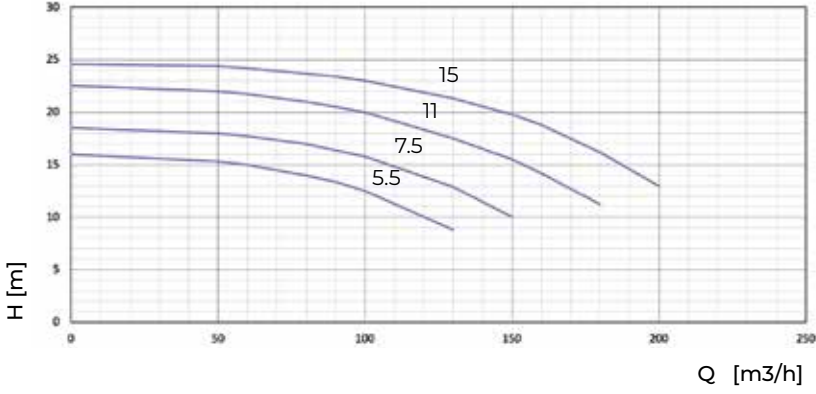
KST 100/315
 PERFORMANS EĞRİLERİ

GİRİŞ(INPUT): DN125 ÇIKIŞ(OUTPUT): DN100 1450 d/dak (l/min)

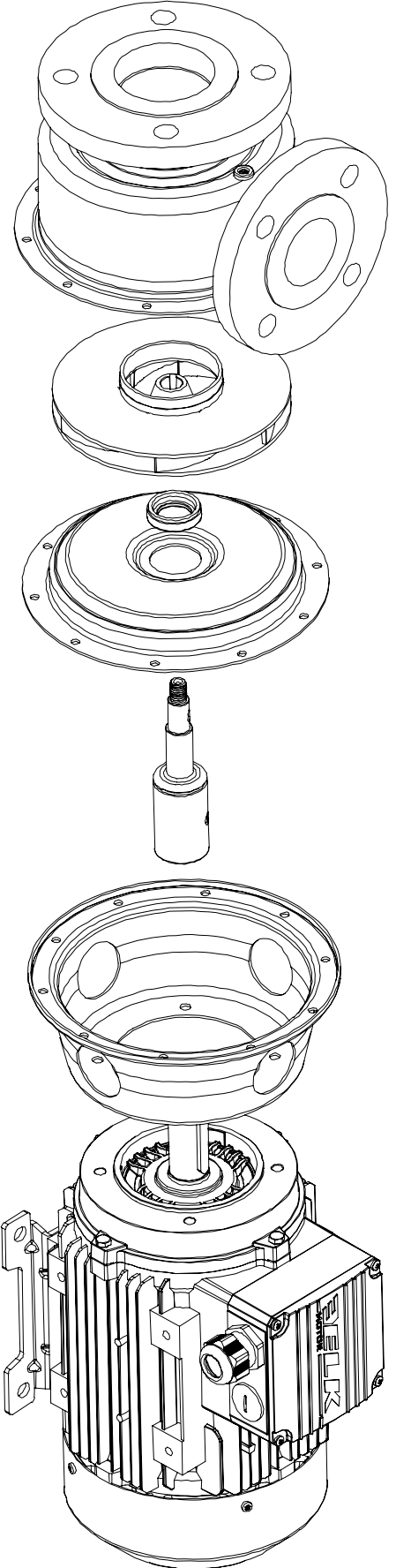
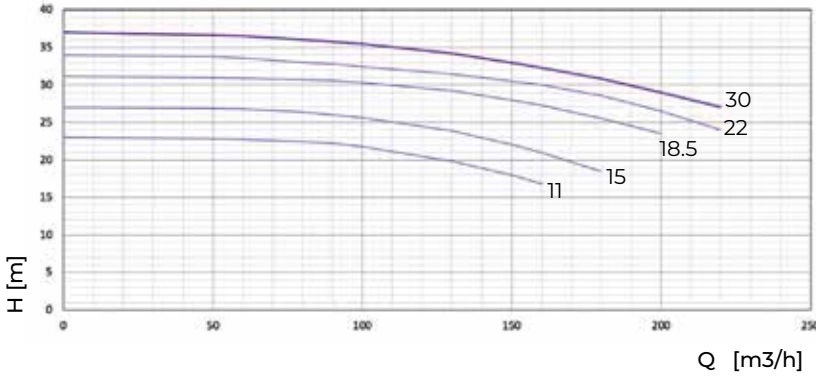

KST 32 SERİSİ

KST 32 SERIES
2900 d/dak (l/min)



PERFORMANS TABLOSU

PERFORMANCE TABLE

POMPA TİPİ PUMP TYPE	kw	GİRİŞ-ÇIKIŞ	m ³ /h	0	6	9	12	16	19	22	25	27
KST 32/125	1,5	50-32	H[m]	27	25	24	22,7	20,7	19	17		
	2,2	50-32		30	28	27	25,8	23,7	22	19,8	17	
	3	50-32		34	32	31	29,8	27,3	25,3	23	20,4	18,5

POMPA TİPİ PUMP TYPE	kw	GİRİŞ-ÇIKIŞ	m ³ /h	0	7	10	12	17	19	22	25	27	32	37
KST 32/160	3	50-32	H[m]	36	34	33	32,3	30,6	29,8	28,6	27,2			
	4	50-32		42	40	39	38,2	36,5	35,6	34,3	33	32		
	5,5	50-32		48	46	45	44	42	41,2	39,8	38,2	37	34	
	7,5	50-32		54	52	50,8	50	48	47	45,6	44	43	40	37

POMPA TİPİ PUMP TYPE	kw	GİRİŞ-ÇIKIŞ	m ³ /h	0	7	10	12	17	19	22	25	27	32	37	42
KST 32/200	4	50-32	H[m]	45	44	43	41,8	39	37,2	35	32	30			
	5,5	50-32		52	50,6	49,5	48,8	46,5	45,2	43,1	40,7	38,8	33,6		
	7,5	50-32		58	56,5	55,5	54,8	53	52	50,3	48,3	47	42,5	37,5	
	11	50-32		63,5	62	61,3	60,6	58,8	58	56,5	55,2	53,8	50,4	46	40

KULLANIM ALANLARI

USAGE AREAS

Endüstriyel tip bulaşık ve çamaşır makinelerinde
Bol debili yıkama sistemlerinde
İçme suyu ve dolun tesislerinde
Isıtma ve soğutma sistemlerinde
Kapalı devre soğutma (Chiller) sistemlerinde
Boyahanelerde boya ve boyalı sıvı basımında
Gıda endüstrisinde (meşrubat, meyve suyu ve süt fabrikalarında)
Isıtma ve hava şartlandırma sistemlerinde
Glikol çözeltilerini basmada
Az aşındırıcı endüstriyel ve kimyasal sıvılarda
Biodizel tesislerde
Baca gazı arıtma sistemlerinde
Meyve ve sebze yıkama makinalarında
Çelik tencere imalatında
Kuruyemiş tuzlama işlemlerinde

Industrial type dishwashers and washing machines
In high flow washing systems
Drinking water and filling facilities
In heating and cooling systems
In closed circuit cooling (Chiller) systems
In dye and dyed liquid printing in dyehouses
In the food industry (beverage, juice and dairy factories)
Heating and air conditioning systems
Pressing glycol solutions
In less corrosive industrial and chemical liquids
Biodiesel in plants
In flue gas treatment systems
In fruit and vegetable washing machines
In the manufacture of steel pots
Nuts salting processes

KST 32/125
 PERFORMANS EĞRİLERİ

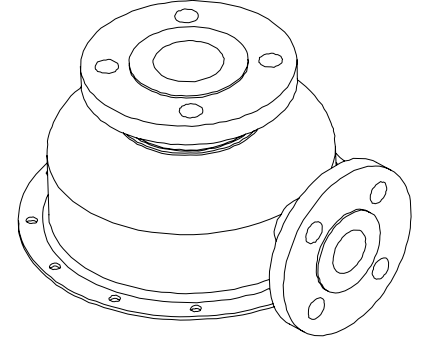
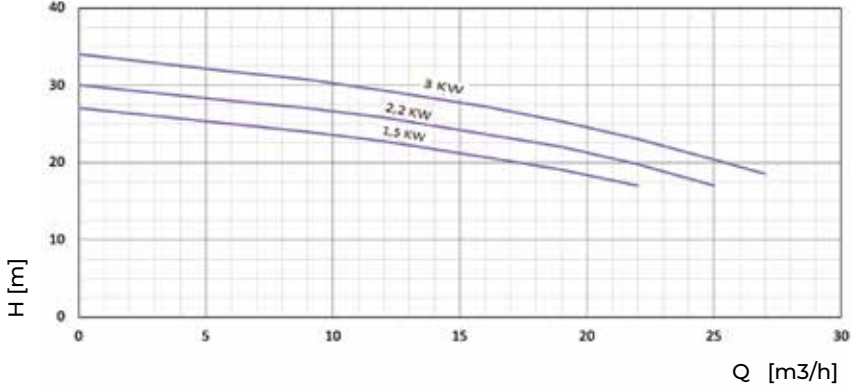
 GİRİŞ(INPUT): DN50 ÇIKIŞ(OUTPUT): DN32 **2900 d/dak (l/min)**

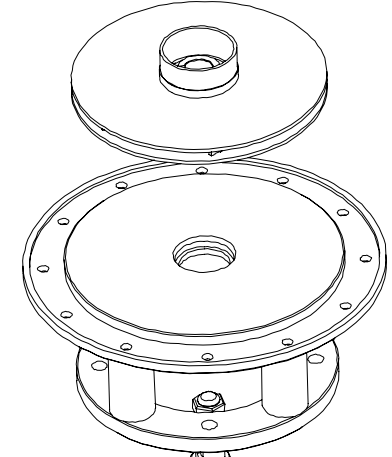
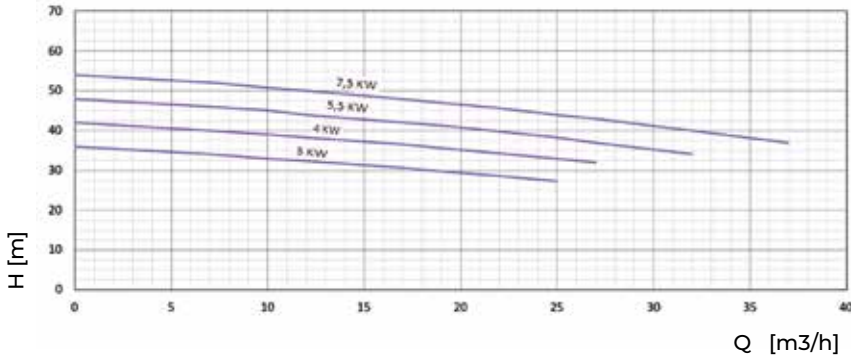
KST 32/160
 PERFORMANS EĞRİLERİ

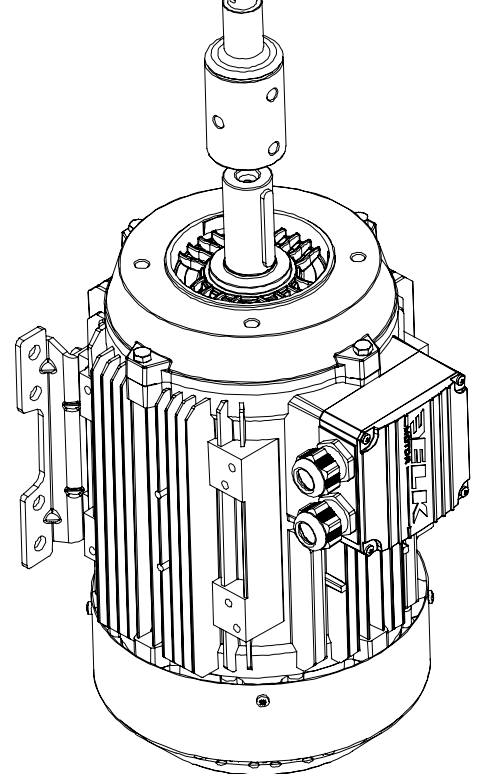
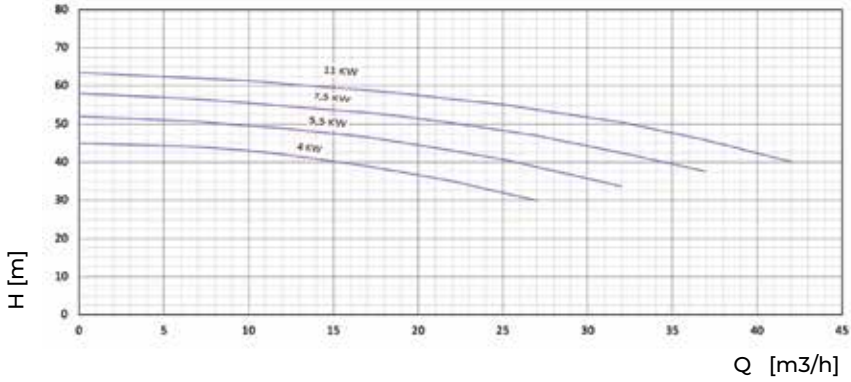
 GİRİŞ(INPUT): DN50 ÇIKIŞ(OUTPUT): DN32 **2900 d/dak (l/min)**

KST 32/200
 PERFORMANS EĞRİLERİ

 GİRİŞ(INPUT): DN50 ÇIKIŞ(OUTPUT): DN32 **2900 d/dak (l/min)**

KST 40 SERİSİ
KST 40 SERIES
2900 d/dak (l/min)



PERFORMANS TABLOSU
PERFORMANCE TABLE

POMPA TİPİ PUMP TYPE	kw	GİRİŞ-ÇIKIŞ	m3/h	0	17	23	27	31	33	38	43
KST 40/125	2,2	65-40	H[m]	25	22	20,5	19	17,2			
	3	65-40		29	26,5	25,2	24,1	22,7	21,8		
	4	65-40		33	30,5	29,6	28,5	27,5	26,8	25	
	5,5	65-40		37	34,4	33,3	32,5	31,5	30,8	29,3	27,5

POMPA TİPİ PUMP TYPE	kw	GİRİŞ-ÇIKIŞ	m3/h	0	17	23	27	31	33	38	43
KST 40/160	4	65-40	H[m]	35	33	32	31	30			
	5,5	65-40		42	40	38,6	37,5	36	35		
	7,5	65-40		50	47	46	45	43,8	43	41	
	11	65-40		55	53	52	51	49,8	49	47	45

POMPA TİPİ PUMP TYPE	kw	GİRİŞ-ÇIKIŞ	m3/h	0	17	23	27	31	33	38	43	49	53	65
KST 40/200	7,5	65-40	H[m]	48	45	43,6	42,5	40,7	39,9	37	33,5	29		
	11	65-40		60	57,5	56	55	53,5	52,8	50,3	47,8	44	41,5	
	15	65-40		71	69	68	67	65,5	65	63	61	58	56	49

POMPA TİPİ PUMP TYPE	kw	GİRİŞ-ÇIKIŞ	m3/h	0	17	23	27	31	38	43	49	53	60
KST 40/250	11	65-40	H[m]	60	57	56	55	54	51	48			
	15	65-40		68	66	65	64	62,8	60	57	53		
	18,5	65-40		75	73	72	71	69,8	67	65	62	59,5	
	22	65-40		82	80	78,8	78	77	75	73,5	71	69	65

KULLANIM ALANLARI
USAGE AREAS

Endüstriyel tip bulaşık ve çamaşır makinelerinde
Bol debili yıkama sistemlerinde
İçme suyu ve dolum tesislerinde
Isıtma ve soğutma sistemlerinde
Kapalı devre soğutma (Chiller) sistemlerinde
Boyanelerde boya ve boyalı sıvı basımında
Gıda endüstrisinde (meşrubat, meyve suyu ve süt fabrikalarında)
Isıtma ve hava şartlandırma sistemlerinde
Glikol çözeltilerini basmada
Az aşındırıcı endüstriyel ve kimyasal sıvılarda
Biodizel tesislerde
Baca gazı arıtma sistemlerinde
Meyve ve sebze yıkama makinalarında
Çelik tencere imalatında
Kuruyemiş tuzlama işlemlerinde

Industrial type dishwashers and washing machines
In high flow washing systems
Drinking water and filling facilities
In heating and cooling systems
In closed circuit cooling (Chiller) systems
In dye and dyed liquid printing in dyehouses
In the food industry (beverage, juice and dairy factories)
Heating and air conditioning systems
Pressing glycol solutions
In less corrosive industrial and chemical liquids
Biodiesel in plants
In flue gas treatment systems
In fruit and vegetable washing machines
In the manufacture of steel pots
Nuts salting processes

KST 40/125
 PERFORMANS EĞRİLERİ

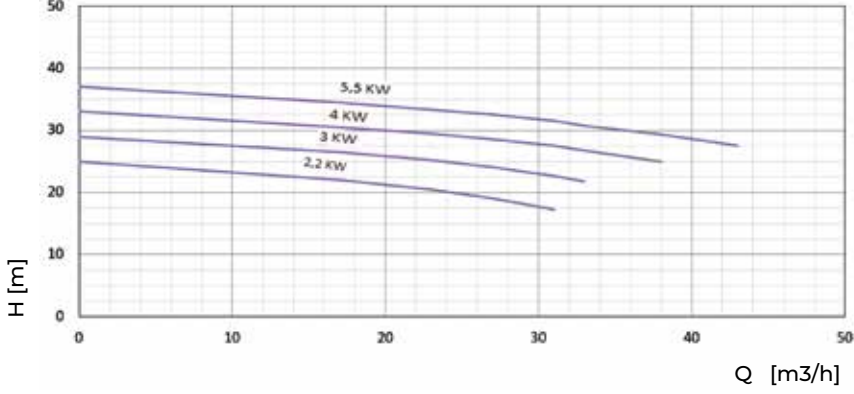
 GİRİŞ(INPUT): DN65 ÇIKIŞ(OUTPUT): DN40 **2900 d/dak (l/min)**

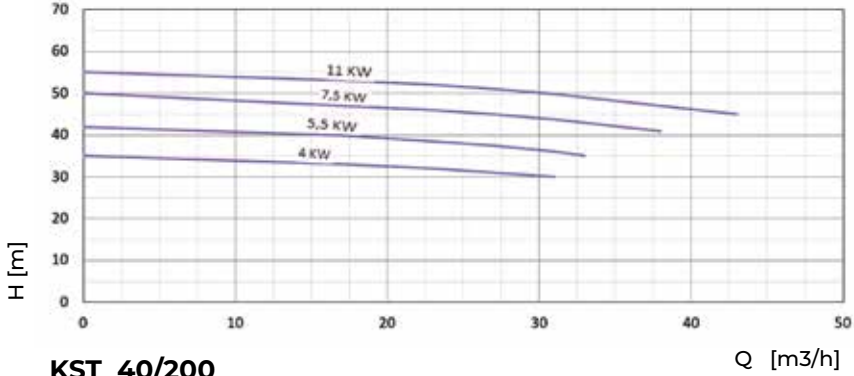
KST 40/160
 PERFORMANS EĞRİLERİ

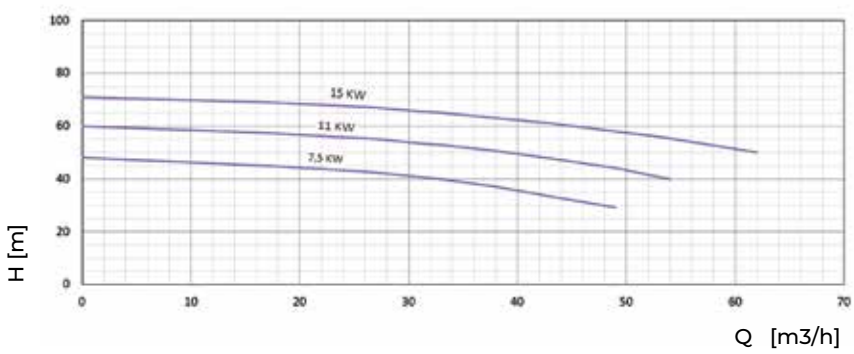
 GİRİŞ(INPUT): DN65 ÇIKIŞ(OUTPUT): DN40 **2900 d/dak (l/min)**

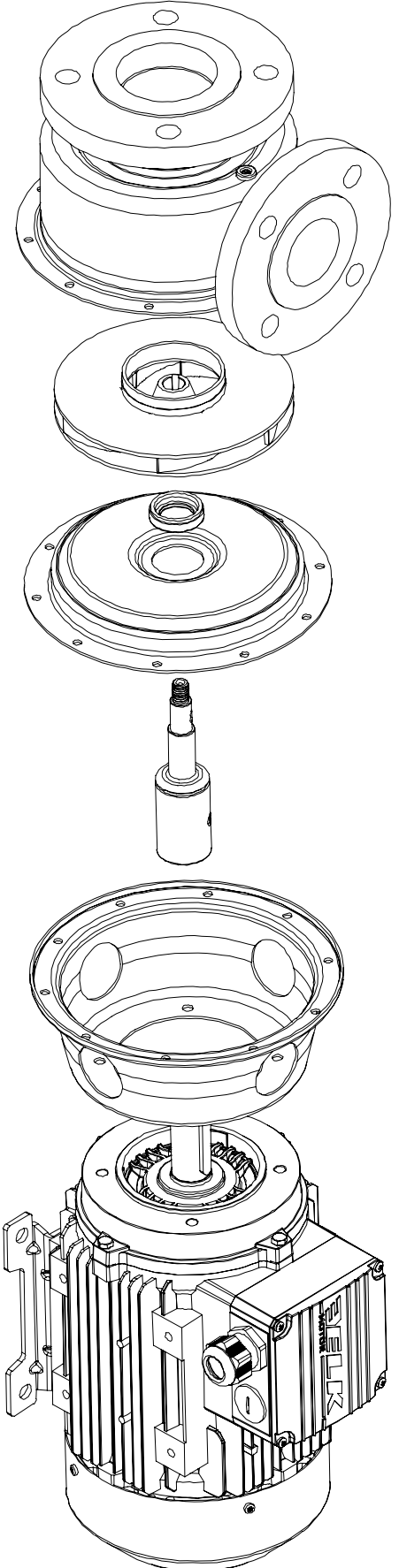
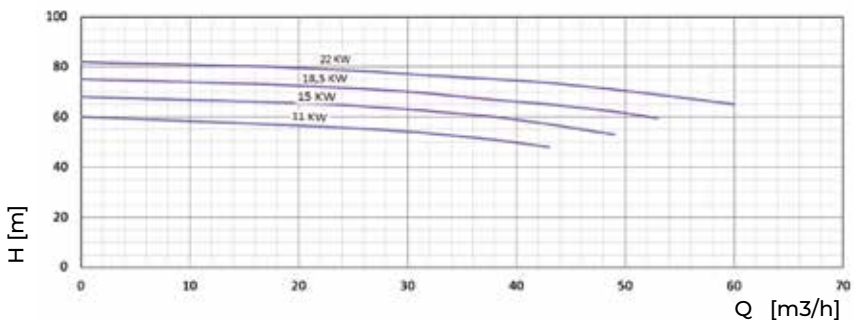
KST 40/200
 PERFORMANS EĞRİLERİ

 GİRİŞ(INPUT): DN65 ÇIKIŞ(OUTPUT): DN40 **2900 d/dak (l/min)**

KST 40/250
 PERFORMANS EĞRİLERİ

 GİRİŞ(INPUT): DN65 ÇIKIŞ(OUTPUT): DN40 **2900 d/dak (l/min)**

KST 50 SERİSİ

KST 50 SERIES

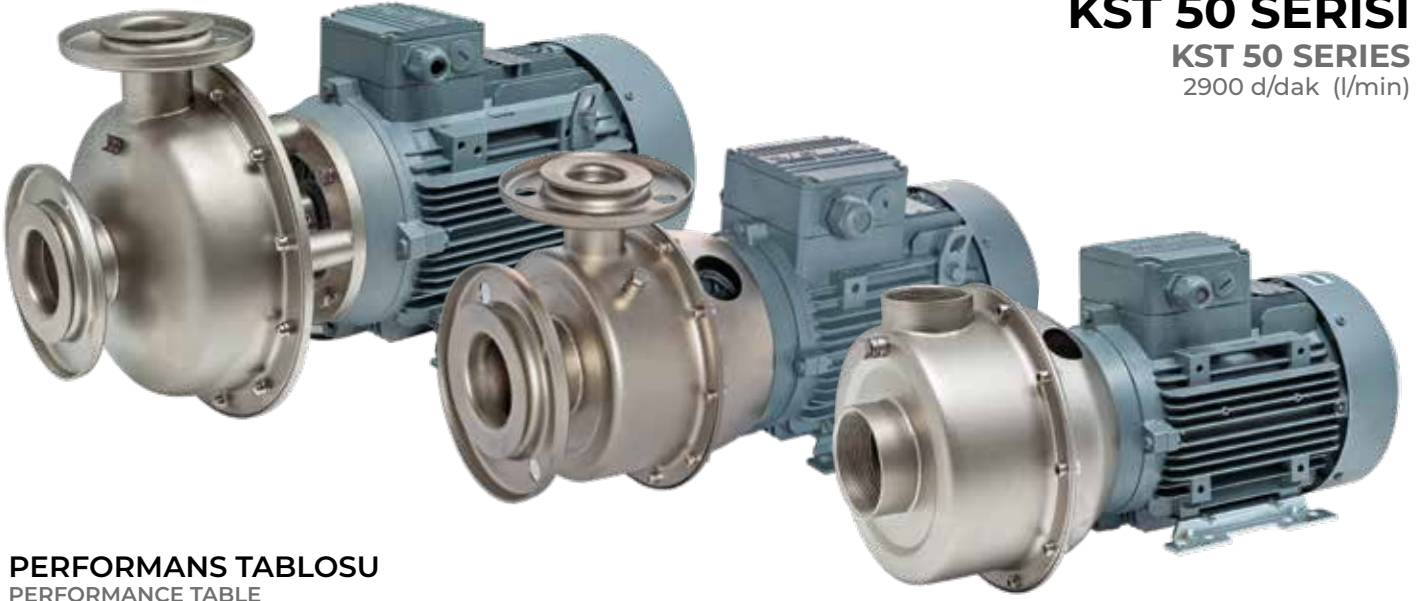
2900 d/dak (l/min)



PERFORMANS TABLOSU

PERFORMANCE TABLE

POMPA TİPİ PUMP TYPE	kw	GİRİŞ-ÇIKIŞ	m ³ /h	0	17	23	27	33	38	43	49	54
KST 50/125	3	65-50	H[m]	22	20	18,8	18	16,5	15			
	4	65-50		27	24,5	23,3	22,5	21	19,5	17,5		
	5,5	65-50		31	28,5	27,4	26,5	25	23,7	22	19,8	
	7,5	65-50		34	31,9	30,9	30,2	29	27,8	26,2	24	22

POMPA TİPİ PUMP TYPE	kw	GİRİŞ-ÇIKIŞ	m ³ /h	0	17	23	27	33	38	43	49	53	60
KST 50/160	5,5	65-50	H[m]	33	31	30	29	27,5	26	24,7	23		
	7,5	65-50		40	38	37	36	34,6	33,3	32	30	28,5	
	11	65-50		48	46	44,8	43,8	42,5	41,2	40	38	36,5	34

POMPA TİPİ PUMP TYPE	kw	GİRİŞ-ÇIKIŞ	m ³ /h	0	17	23	38	49	53	68	83	93	105
KST 50/200	11	65-50	H[m]	51	48,5	47,5	45	42,8	41,7	38			
	15	65-50		57	55	54,2	51,5	49,2	48,4	44,8	41		
	18,5	65-50		63	60,7	59,8	56,9	55	54,5	51,7	48,5	46	
	22	65-50		69	67	66,2	64	62,5	61,8	59	56,4	54,5	52

POMPA TİPİ PUMP TYPE	kw	GİRİŞ-ÇIKIŞ	m ³ /h	0	17	23	31	38	49	53	68	83	93	102
KST 50/250	18,5	65-50	H[m]	67	64,5	63,5	62,3	61,2	59	58,3	55	52	50	
	22	65-50		74	71,3	70,5	69	68	66	65	62	59,3	57,5	55,5

KULLANIM ALANLARI

USAGE AREAS

Endüstriyel tip bulaşık ve çamaşır makinelerinde
Bol debili yıkama sistemlerinde
İçme suyu ve dolum tesislerinde
Isıtma ve soğutma sistemlerinde
Kapalı devre soğutma (Chiller) sistemlerinde
Boyahanelerde boya ve boyalı sıvı basımında
Gıda endüstrisinde (meşrubat, meyve suyu ve süt fabrikalarında)
Isıtma ve hava şartlandırma sistemlerinde
Glikol çözeltilerini basmada
Az aşındırıcı endüstriyel ve kimyasal sıvılarda
Biodizel tesislerde
Baca gazı arıtma sistemlerinde
Meyve ve sebze yıkama makinalarında
Çelik tencere imalatında
Kuruyemiş tuzlama işlemlerinde

Industrial type dishwashers and washing machines
In high flow washing systems
Drinking water and filling facilities
In heating and cooling systems
In closed circuit cooling (Chiller) systems
In dye and dyed liquid printing in dyehouses
In the food industry (beverage, juice and dairy factories)
Heating and air conditioning systems
Pressing glycol solutions
In less corrosive industrial and chemical liquids
Biodiesel in plants
In flue gas treatment systems
In fruit and vegetable washing machines
In the manufacture of steel pots
Nuts salting processes

KST 50/125 PERFORMANS EĞRİLERİ

GİRİŞ(INPUT): DN65 ÇIKIŞ(OUTPUT): DN50 2900 d/dak (l/min)

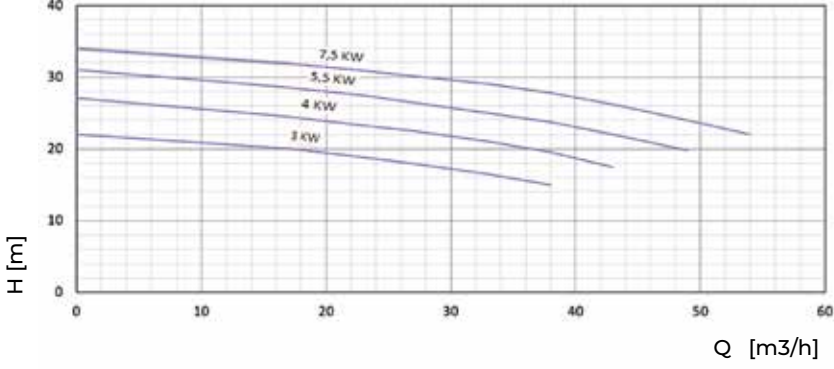

KST 50/160 PERFORMANS EĞRİLERİ

GİRİŞ(INPUT): DN65 ÇIKIŞ(OUTPUT): DN50 2900 d/dak (l/min)

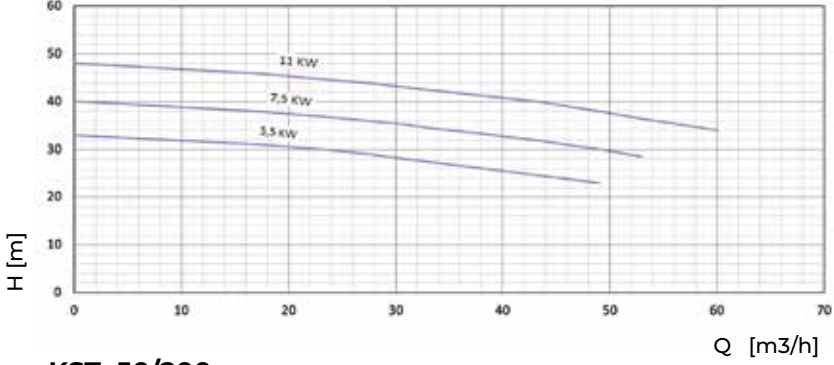

KST 50/200 PERFORMANS EĞRİLERİ

GİRİŞ(INPUT): DN65 ÇIKIŞ(OUTPUT): DN50 2900 d/dak (l/min)

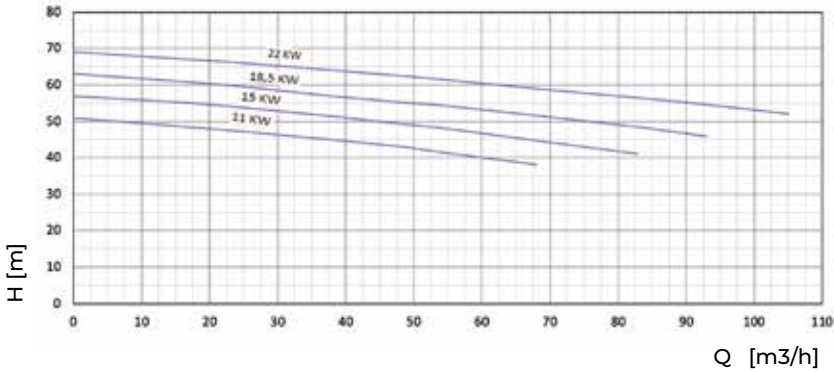

KST 50/250 PERFORMANS EĞRİLERİ

GİRİŞ(INPUT): DN65 ÇIKIŞ(OUTPUT): DN50 2900 d/dak (l/min)

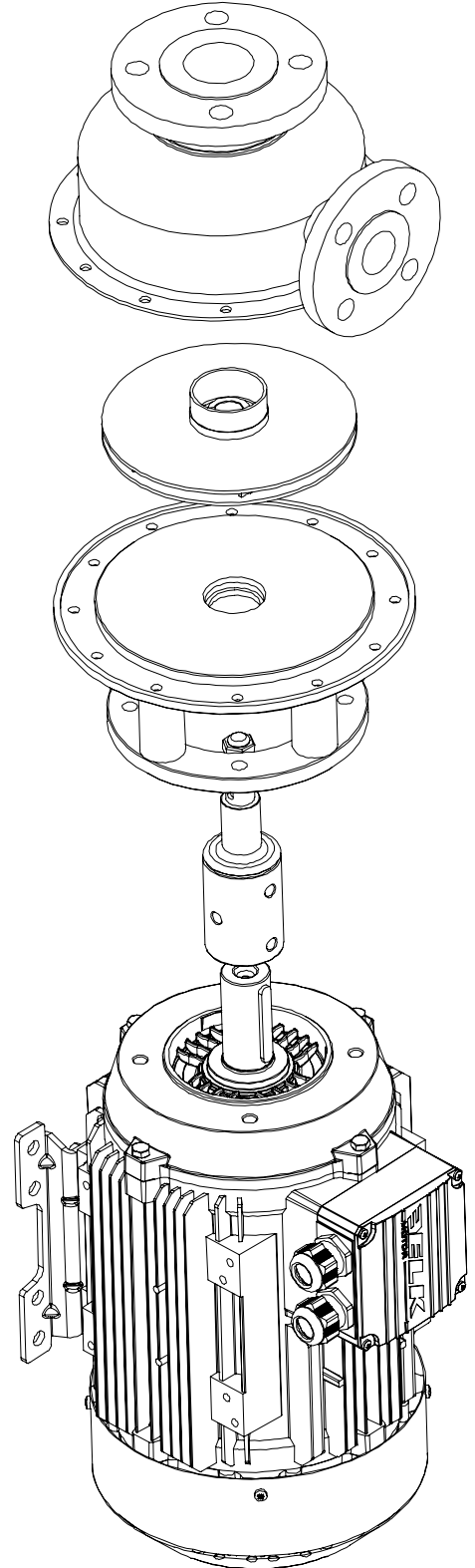
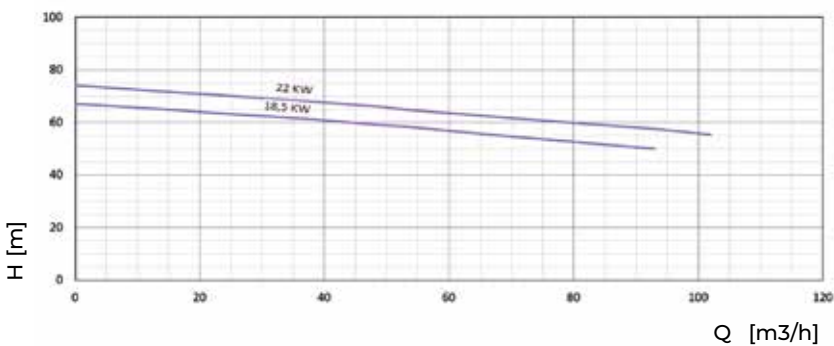

KST 65 SERİSİ
KST 65 SERIES
2900 d/dak (l/min)

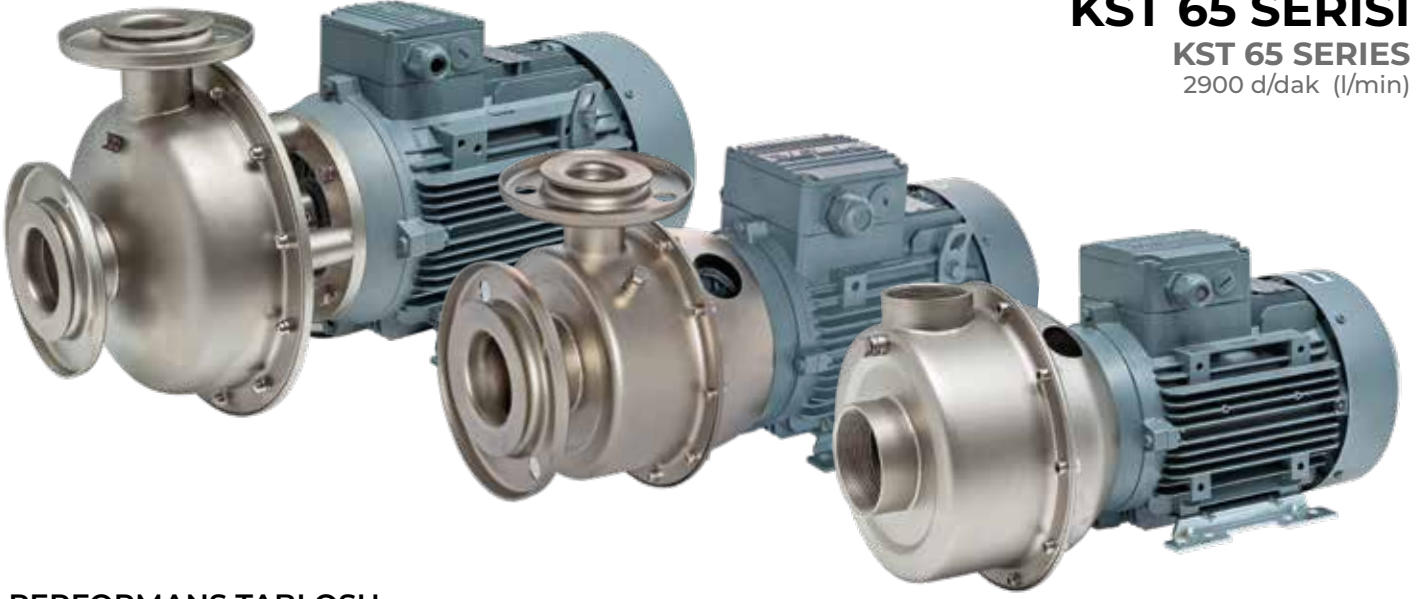

PERFORMANS TABLOSU
PERFORMANCE TABLE

POMPA TİPİ PUMP TYPE	kw	GİRİŞ-ÇIKIŞ	m3/h	0	18	33	53	58	65	78	88	99
KST 65/125	4	80-65	H[m]	21	20	19	17,6	17,2	16,5			
	5,5	80-65		25	24	23	21,3	21	20,4	19,3		
	7,5	80-65		29	28	27	25,4	25	24,2	23	22	
	11	80-65		33	32	31	29,4	29	28,4	27,3	26,3	25

POMPA TİPİ PUMP TYPE	kw	GİRİŞ-ÇIKIŞ	m3/h	0	17	23	27	33	38	43	49	53	60
KST 65/160	11	80-65	H[m]	33	31	30	29	27,5	26	24,7	23		
	15	80-65		40	38	37	36	34,6	33,3	32	30	28,5	
	18,5	80-65		48	46	44,8	43,8	42,5	41,2	40	38	36,5	34

POMPA TİPİ PUMP TYPE	kw	GİRİŞ-ÇIKIŞ	m3/h	0	53	65	78	88	99	118	133	143	155
KST 65/200	18,5	80-65	H[m]	52	49	48	46,5	45	43	39	34	30	
	22	80-65		60	56	55	53,5	52,5	51	48	44	40,5	35

KULLANIM ALANLARI
USAGE AREAS

Endüstriyel tip bulaşık ve çamaşır makinelerinde
Bol debili yıkama sistemlerinde
İçme suyu ve dolun tesislerinde
Isıtma ve soğutma sistemlerinde
Kapalı devre soğutma (Chiller) sistemlerinde
Boyahanelerde boya ve boyalı sıvı basımında
Gıda endüstrisinde (meşrubat, meyve suyu ve süt fabrikalarında)
Isıtma ve hava şartlandırma sistemlerinde
Glikol çözeltilerini basmada
Az aşındırıcı endüstriyel ve kimyasal sıvılarda
Biodizel tesislerde
Baca gazı arıtma sistemlerinde
Meyve ve sebze yıkama makinalarında
Çelik tencere imalatında
Kuruyemiş tuzlama işlemlerinde

Industrial type dishwashers and washing machines
In high flow washing systems
Drinking water and filling facilities
In heating and cooling systems
In closed circuit cooling (Chiller) systems
In dye and dyed liquid printing in dyehouses
In the food industry (beverage, juice and dairy factories)
Heating and air conditioning systems
Pressing glycol solutions
In less corrosive industrial and chemical liquids
Biodiesel in plants
In flue gas treatment systems
In fruit and vegetable washing machines
In the manufacture of steel pots
Nuts salting processes

KST 65/125
 PERFORMANS EĞRİLERİ

GİRİŞ(INPUT): DN80 ÇIKIŞ(OUTPUT): DN65

2900 d/dak (l/min)

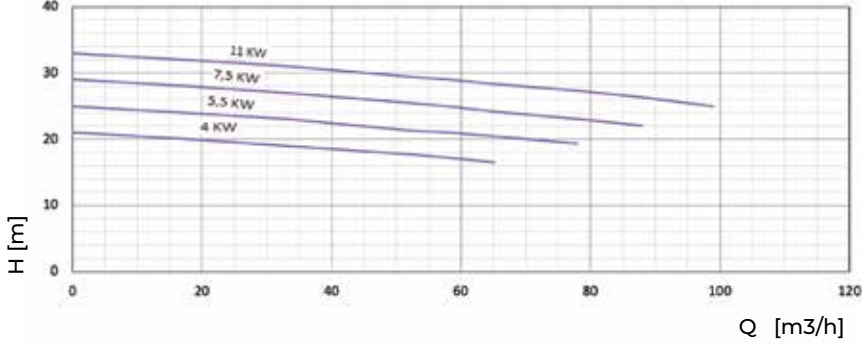
KST 65/160
 PERFORMANS EĞRİLERİ

GİRİŞ(INPUT): DN80 ÇIKIŞ(OUTPUT): DN65

2900 d/dak (l/min)

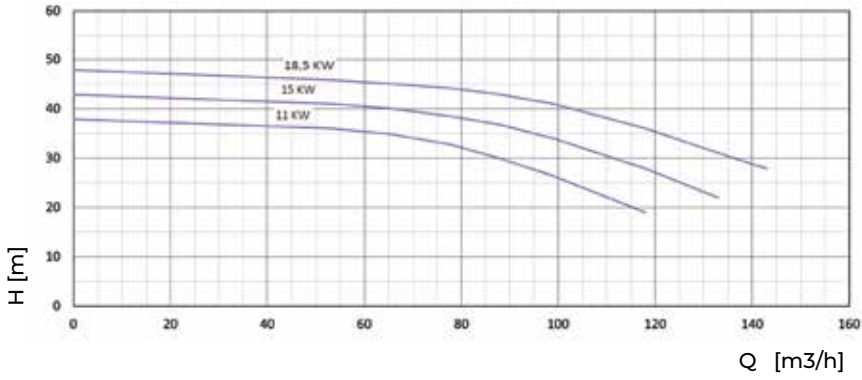
KST 65/200
 PERFORMANS EĞRİLERİ

GİRİŞ(INPUT): DN80 ÇIKIŞ(OUTPUT): DN65

2900 d/dak (l/min)

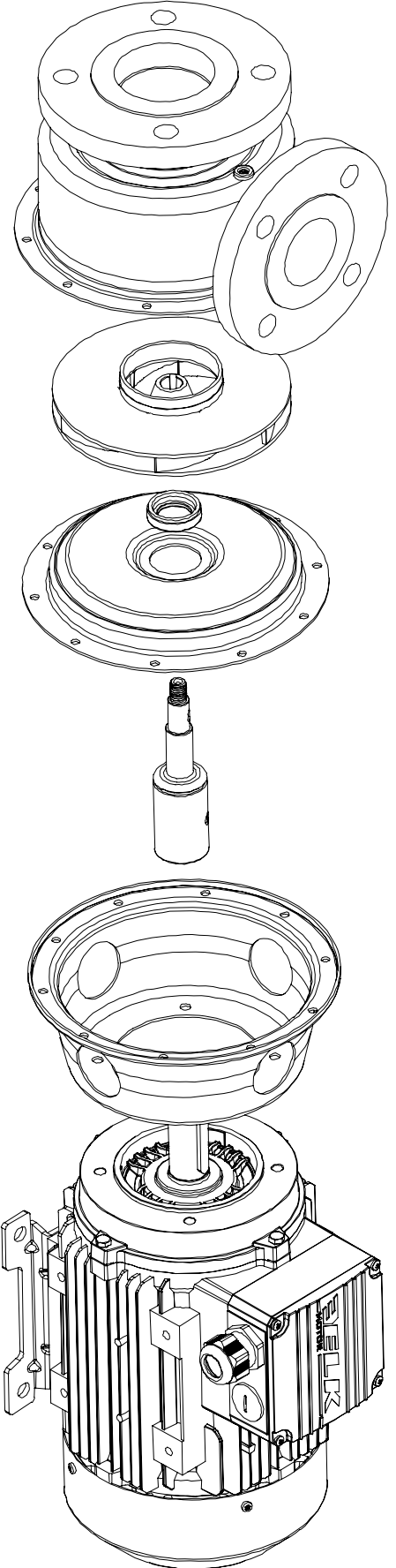
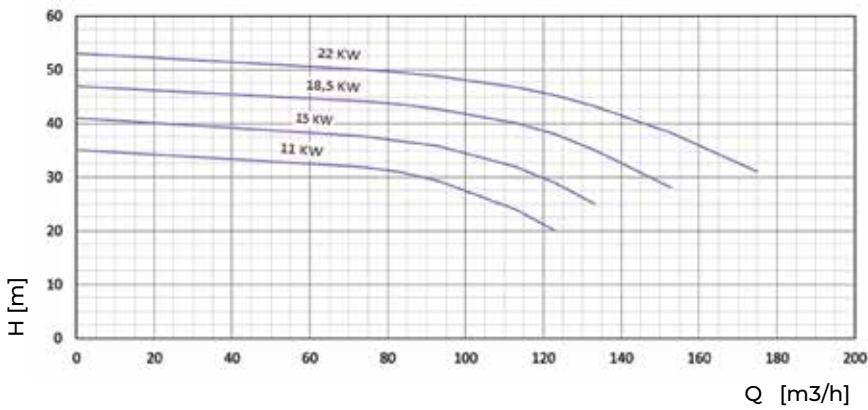

KST 80 SERİSİ
KST 80 SERIES
2900 d/dak (l/min)



PERFORMANS TABLOSU
PERFORMANCE TABLE

POMPA TİPİ PUMP TYPE	kw	GİRİŞ-ÇIKIŞ	m ³ /h	0	73	83	93	113	123	133	153	175
KST 80/200	11	100-80	H[m]	35	32	31	29,3	24	20			
	15	100-80		41	37,6	36,8	35,8	32	29	25		
	18,5	100-80		47	44,2	43,6	42,7	40	38	35	28	
	22	100-80		53	50	49,6	48,7	46,8	45,3	43,3	38,3	31

KST 80/200
PERFORMANS EĞRİLERİ

GİRİŞ(INPUT): DN100 ÇIKIŞ(OUTPUT): DN80

2900 d/dak (l/min)

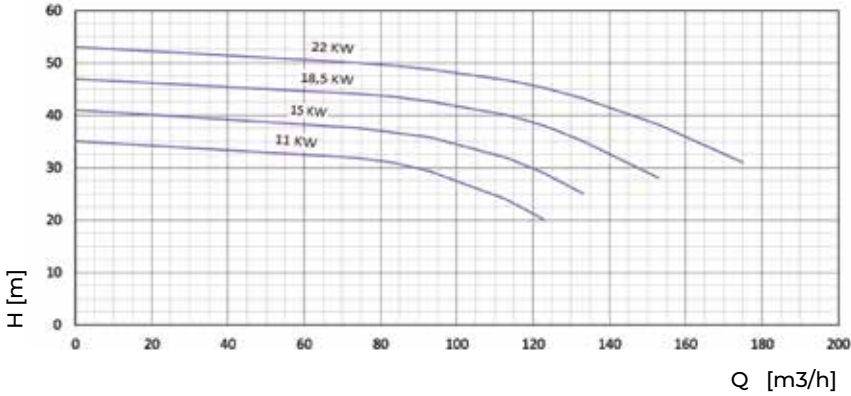

KULLANIM ALANLARI
USAGE AREAS

Endüstriyel tip bulaşık ve çamaşır makinelerinde
Bol debili yıkama sistemlerinde
İçme suyu ve dolum tesislerinde
Isıtma ve soğutma sistemlerinde
Kapalı devre soğutma (Chiller) sistemlerinde
Boyahanelerde boya ve boyalı sıvı basımında
Gıda endüstrisinde (meşrubat, meyve suyu ve süt fabrikalarında)
Isıtma ve hava şartlandırma sistemlerinde
Glikol çözeltilerini basmada
Az aşındırıcı endüstriyel ve kimyasal sıvılarda
Biodizel tesislerde
Baca gazı arıtma sistemlerinde
Meyve ve sebze yıkama makinalarında
Çelik tencere imalatında
Kuruyemiş tuzlama işlemlerinde

Industrial type dishwashers and washing machines
In high flow washing systems
Drinking water and filling facilities
In heating and cooling systems
In closed circuit cooling (Chiller) systems
In dye and dyed liquid printing in dyehouses
In the food industry (beverage, juice and dairy factories)
Heating and air conditioning systems
Pressing glycol solutions
In less corrosive industrial and chemical liquids
Biodiesel in plants
In flue gas treatment systems
In fruit and vegetable washing machines
In the manufacture of steel pots
Nuts salting processes



2M-KST 32 SERİSİ

2M-KST 32 SERIES

2900 d/dak (l/min)



2M-KST 32/160

PERFORMANS TABLOSU

PERFORMANCE TABLE

POMPA TİPİ PUMP TYPE	kw	GİRİŞ-ÇIKIŞ	m ³ /h	2	4	6	8	10
2M-KST 32/160	1,5	1,1/2"-1,1/4"	H[m]	60	53,5	46	39	30
	2,2	1,1/2"-1,1/4"		61,5	56	50	43	35
	3	1,1/2"-1,1/4"		63	59	54	48	40

2M-KST 32/160

PERFORMANS EĞRİLERİ

GİRİŞ(INPUT): 1,1/2" ÇIKIŞ(OUTPUT): 1,1/4"

2900 d/dak (l/min)

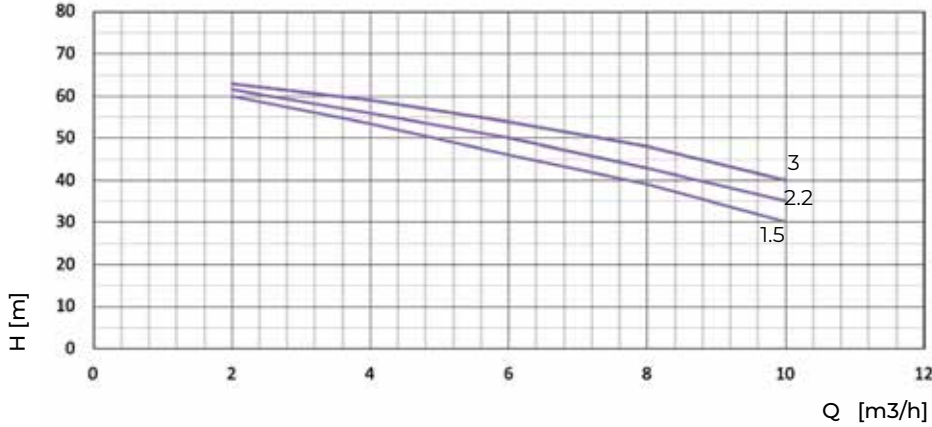

KULLANIM ALANLARI

USAGE AREAS

Endüstriyel tip bulaşık ve çamaşır makinelerinde
Bol debili yıkama sistemlerinde
İçme suyu ve dolum tesislerinde
Isıtma ve soğutma sistemlerinde
Kapalı devre soğutma (Chiller) sistemlerinde
Boyahanelerde boya ve boyalı sıvı basımında
Gıda endüstrisinde (meşrubat, meyve suyu ve süt fabrikalarında)
Isıtma ve hava şartlandırma sistemlerinde
Glikol çözeltilerini basmada
Az aşındırıcı endüstriyel ve kimyasal sıvılarda
Biodizel tesislerde
Baca gazı arıtma sistemlerinde
Meyve ve sebze yıkama makinalarında
Çelik tencere imalatında
Kuruyemiş tuzlama işlemlerinde

Industrial type dishwashers and washing machines
In high flow washing systems
Drinking water and filling facilities
In heating and cooling systems
In closed circuit cooling (Chiller) systems
In dye and dyed liquid printing in dyehouses
In the food industry (beverage, juice and dairy factories)
Heating and air conditioning systems
Pressing glycol solutions
In less corrosive industrial and chemical liquids
Biodiesel in plants
In flue gas treatment systems
In fruit and vegetable washing machines
In the manufacture of steel pots
Nuts salting processes

3M-KST 32 SERİSİ

3M-KST 32 SERIES

2900 d/dak (l/min)



3M-KST 32/160

PERFORMANS TABLOSU

PERFORMANCE TABLE

POMPA TİPİ PUMP TYPE	kw	GİRİŞ-ÇIKIŞ	m ³ /h	0	2	4	5	6	7	8	9	10	11	12	13
3M-KST 32/160	3	1,1/2"-1"	H[m]	90	87	78	70	60	50	40	30	20	10		
	4	1,1/2"-1"		91	90	85	79	70	60	50	40	30	20	10	
	5,5	1,1/2"-1"		93	92	89	85	79	70	60	50	40	30	20	10

3M-KST 32/160

PERFORMANS EĞRİLERİ

GİRİŞ (INPUT): 1,1/2" ÇIKIŞ (OUTPUT): 1"

2900 d/dak (l/min)

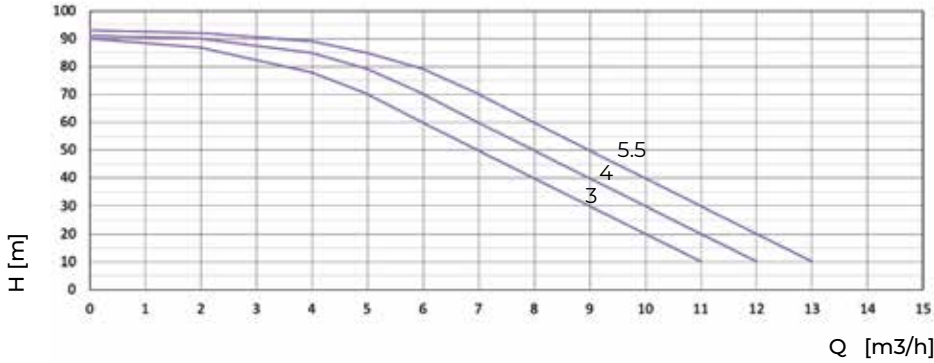

KULLANIM ALANLARI

USAGE AREAS

Endüstriyel tip bulaşık ve çamaşır makinelerinde
Bol debili yıkama sistemlerinde
İçme suyu ve dolum tesislerinde
Isıtma ve soğutma sistemlerinde
Kapalı devre soğutma (Chiller) sistemlerinde
Boyahanelerde boya ve boyalı sıvı basımında
Gıda endüstrisinde (meşrubat, meyve suyu ve süt fabrikalarında)
Isıtma ve hava şartlandırma sistemlerinde
Glikol çözeltilerini basmada
Az aşındırıcı endüstriyel ve kimyasal sıvılarda
Biodizel tesislerde
Baca gazı arıtma sistemlerinde
Meyve ve sebze yıkama makinalarında
Çelik tencere imalatında
Kuruyemiş tuzlama işlemlerinde

Industrial type dishwashers and washing machines
In high flow washing systems
Drinking water and filling facilities
In heating and cooling systems
In closed circuit cooling (Chiller) systems
In dye and dyed liquid printing in dyehouses
In the food industry (beverage, juice and dairy factories)
Heating and air conditioning systems
Pressing glycol solutions
In less corrosive industrial and chemical liquids
Biodiesel in plants
In flue gas treatment systems
In fruit and vegetable washing machines
In the manufacture of steel pots
Nuts salting processes



SF SERİSİ
SF SERIES
2900 d/dak (l/min)

PERFORMANS TABLOSU
PERFORMANCE TABLE

POMPA TİPİ PUMP TYPE	kw	GİRİŞ-ÇIKIŞ	m ³ /h	0	0,3	0,6	1,2	1,8	2,1	2,4	2,7
SF 25	0,37	1"-1"	H[m]	41	36	31	22	12	7		
	0,55	1"-1"		65	58	51	37	23	16	9	
	0,75	1"-1"		70	62,5	55	40	26	19	12	5

SF-25
PERFORMANS EĞRİLERİ

GİRİŞ(INPUT): 1" ÇIKIŞ(OUTPUT): 1"

2900 d/dak (l/min)

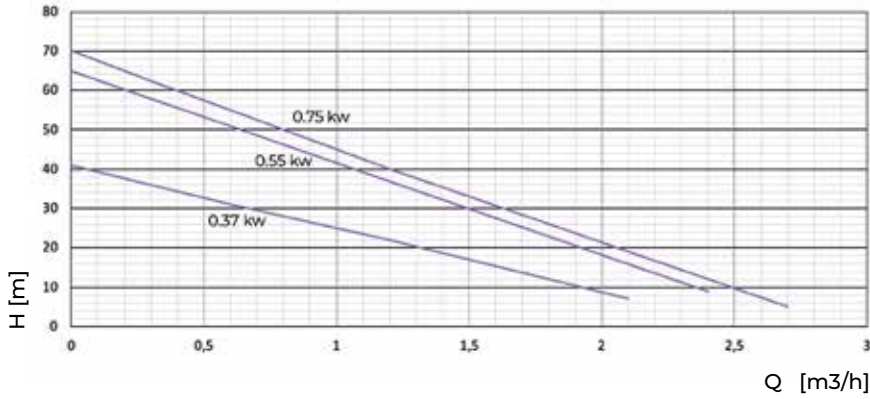

ÖZELLİKLERİ
PROPERTIES

Paslanmaz fanlı
Sıvı sıcaklığı maksimum +85 °C
Tek fazlı motorlar termal aşırı yük koruyuculu
AISI304 malzeme kaynaklı motor mili
NBR / Seramik / Grafit mekanik salmastra
Çalışma basıncı maksimum 8 bar
Bakır tel sargı
Maksimum ortalama sıcaklığı +40 °C
Maksimum emiş 9 metre

With stainless fan
Liquid temperature maximum +85 °C
Single-phase motors with thermal overload protector
AISI304 material welded motor shaft
NBR / Ceramic / Graphite mechanical seal
Working pressure maximum 8 bar
Copper wire winding
Maximum average temperature +40 °C
Max suction 9 meters

JETSU SERİSİ

JETSU SERIES
2900 d/dak (l/min)



PERFORMANS TABLOSU

PERFORMANCE TABLE

POMPA TİPİ PUMP TYPE	kw	GİRİŞ-ÇIKIŞ	m ³ /h	0	1,2	1,8	2,4	3	3,6	4,2
J-50	0,75	1"-1"	H[m]	50	42	37	32	28		
J-100	1,1	1, 1/4"-1"		58	50	45	39	33	24	10
J-150	1,1	1, 1/4"-1"		62	54	49	44	38	30	17

J-25 PERFORMANS EĞRİLERİ

2900 d/dak (l/min)

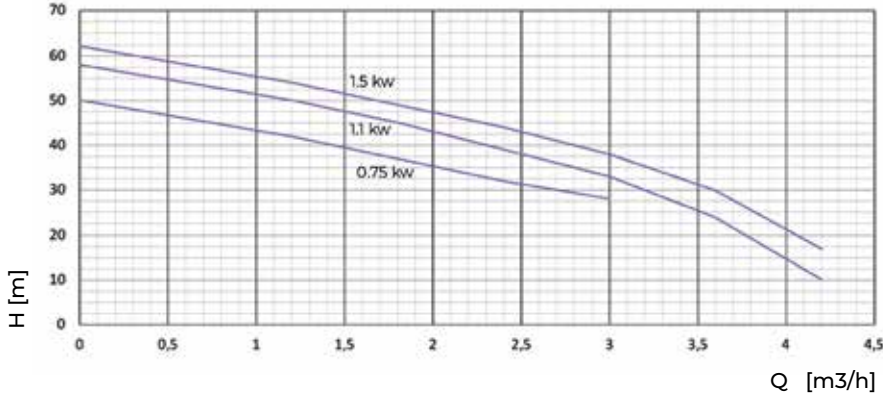

ÖZELLİKLERİ PROPERTIES

Maksimum su sıcaklığı 40 °C
Maksimum emiş 9 mt
Termik korumalı
Pirinç fan

Maximum water temperature 40 °C
Maximum suction 9 meters
Thermal protected
Brass fan



P-JET SU SERİSİ

P-JET SU SERIES

2900 d/dak (l/min)

PERFORMANS TABLOSU

PERFORMANCE TABLE

POMPA TİPİ PUMP TYPE	kw	GİRİŞ-ÇIKIŞ 1"-1"	m ³ /h	0	0,6	1,2	1,8	2,4	2,7
P-JET SU	0,75	1"-1"	H[m]	50	45	40	35	30	27

P-JET SU

PERFORMANS EĞRİLERİ

GİRİŞ(INPUT): 1" ÇIKIŞ(OUTPUT): 1"

2900 d/dak (l/min)

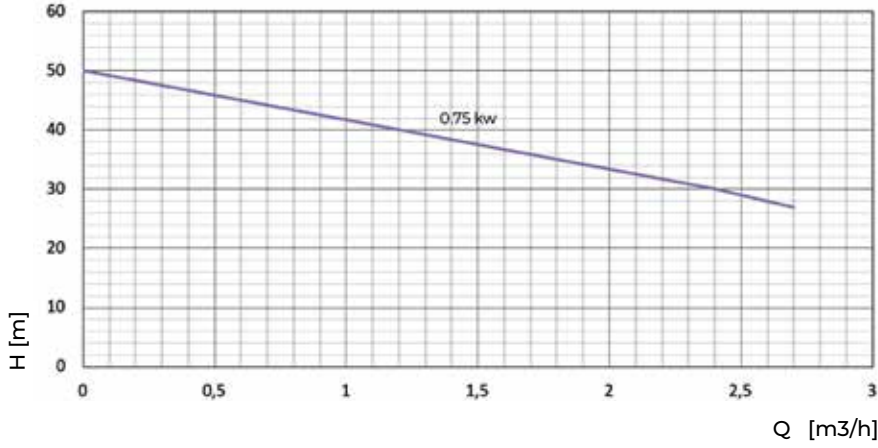

ÖZELLİKLERİ

PROPERTIES

Paslanmaz fanlı
Sıvı sıcaklığı maksimum +85 °C
Tek fazlı motorlar termal aşırı yük koruyuculu
AISI304 malzeme kaynaklı motor mili
NBR / Seramik / Grafit mekanik salmastra
Çalışma basıncı maksimum 8 bar
Bakır tel sargı
Maksimum ortalama sıcaklığı +40 °C
Maksimum emiş 9 metre

With stainless fan
Liquid temperature maximum +85 °C
Single-phase motors with thermal overload protector
AISI304 material welded motor shaft
NBR / Ceramic / Graphite mechanical seal
Working pressure maximum 8 bar
Copper wire winding
Maximum average temperature +40 °C
Max suction 9 meters

2WCO SERİSİ

2WCO SERIES
2900 d/dak (l/min)



PERFORMANS TABLOSU

PERFORMANCE TABLE

POMPA TİPİ PUMP TYPE	kw	GİRİŞ-ÇIKIŞ	m ³ /h	0	1,2	2,4	3,6	4,8	6	7,2	8,4
2WCO-110	1,1	1"-1"	H[m]	45	41	35	28	18	6		
2WCO-150	1,5	1, 1/4"-1"		50	47	43	38	32	25	16	
2WCO-220	2,2	1, 1/4"-1"		57	54	51	47	42	36	28	20

2WCO

PERFORMANS EĞRİLERİ

2900 d/dak (l/min)

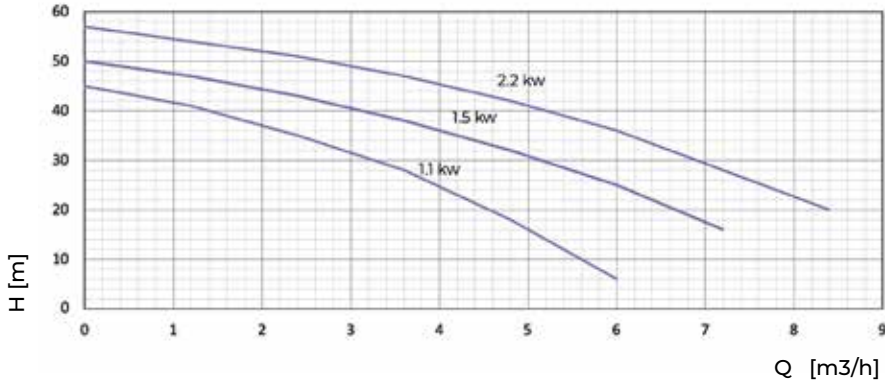

ÖZELLİKLERİ

PROPERTIES

Çift piriç fanlı
Sıvı sıcaklığı maksimum +85 °C
Tek fazlı motorlar termal aşırı yük koruyuculu
AISI304 malzeme kaynaklı motor mili
NBR / Seramik grafit / Mekanik salmastra
Çalışma basıncı maksimum 8 bar
Bakır tel sargı
Maksimum ortam sıcaklığı +40 °C
Maksimum emiş 6-7 metre

With double brass fan
Liquid temperature maximum +85 °C
Single-phase motors with thermal overload protector
AISI304 material welded motor shaft
NBR / Ceramic graphite / Mechanical seal
Working pressure maximum 8 bar
Copper wire winding
Maximum ambient temperature +40 °C
Maximum suction 6-7 meters

CTM SERİSİ

CTM SERIES

3000 d/dak (l/min)



CTM manyetik kaplinli pompalar, gücün motordan çarka doğru manyetik bir kaplin aracılığı ile iletildiği santrifüj tip pompalardır. CTM pompalar, kimyasal transferi ve yüzey işleme endüstrilerinde sirkülasyon için dizayn edilmiş ve üretilmiştir. CTM, kimyasal olarak korozif ve toksik sıvılar için mükemmel seçimdir.

CTM magnetic coupling pumps are centrifugal type pumps in which the power is transmitted from the motor to the impeller by means of a magnetic coupling. CTM pumps are designed and manufactured for circulation in the chemical transfer and surface treatment industries. CTM is the perfect choice for chemically corrosive and toxic liquids.

PERFORMANS TABLOSU

PERFORMANCE TABLE

POMPA TİPİ PUMP TYPE	kw	GİRİŞ-ÇIKIŞ	m ³ /h	DEVİR	BASINÇ MAX	DEBİ
CTM 20-7P	0,12	¾" - ¾"	H[m]	3000	7	3
CTM 25-8P	0,25	1"-1"	H[m]	3000	8	6
CTM 25-10P	0,55	1"-1"	H[m]	3000	13.5	10
CTM 32-12.5P	1,1	1¼" - 1"	H[m]	3000	18	10
CTM 40-12.5P	2,2	1½" - 1¼"	H[m]	3000	18	17
CTM 50-12.5P	3	2" - 1½"	H[m]	3000	22	24

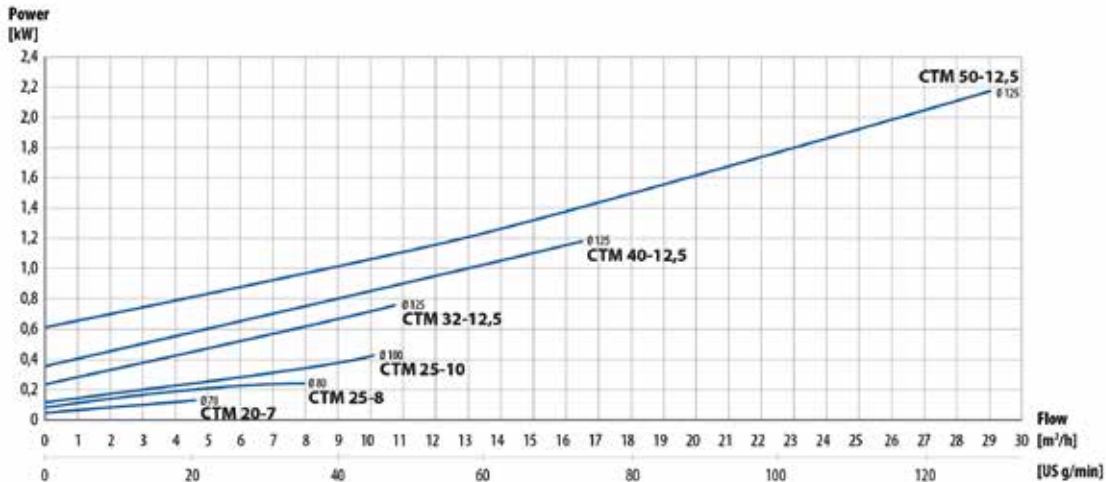
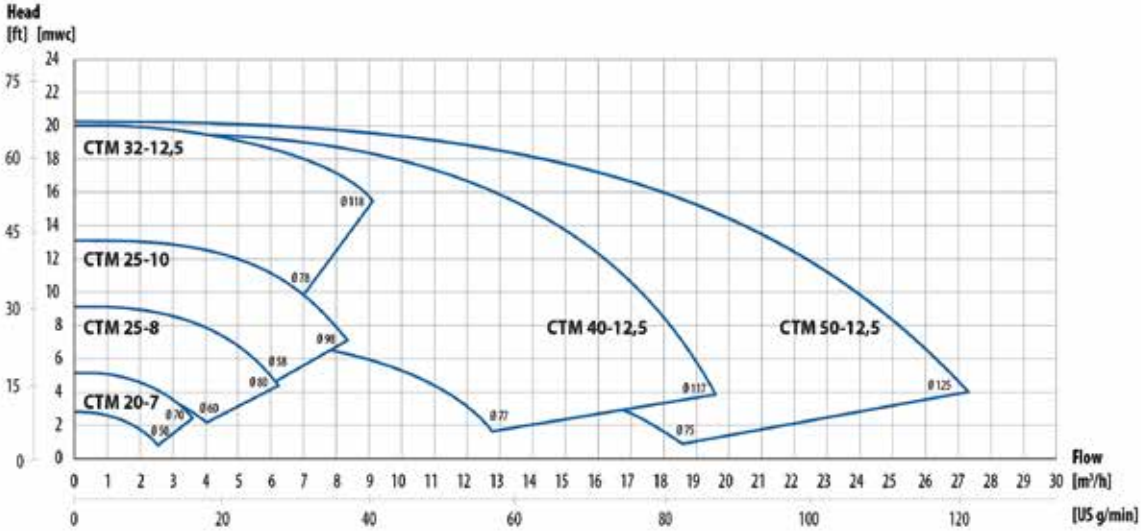

Teknik veriler

Boyutlar

Model	CTM20-7	CTM25-8	CTM25-10	CTM32-12.5	CTM40-12.5	CTM50-12.5	
A	70	90	100	105	105	110	
B	2.76	3.54	3.94	4.13	4.13	4.33	
C	48	58.50	63	56	56.5	54	
	1.89	2.30	2.48	2.20	2.22	2.13	
ØE	93.5	100.5	136.5	164	165	189	
	3.68	3.96	5.37	6.46	6.50	7.44	
ØF	15	18	18	15	23	30.8	
	0.59	0.71	0.71	0.59	0.91	1.21	
G	15	18	18	23	30.5	42	
	0.59	0.71	0.71	0.91	1.20	1.65	
H	1 1/4"	1"	1"	1 1/4"	1 1/4"	2"	
	3/4	1	1	1 1/4	1 1/4	2	
L	1 1/4"	1"	1"	1"	1 1/4"	1 1/2"	
	3/4	1	1	1	1 1/4	1 1/2	
M	248.5	279	334.5	370	402.5	446	
	9.78	10.98	13.17	14.74	15.85	17.56	
N	36	40	45	54.5	56	63	
	1.42	1.57	1.77	2.15	2.20	2.48	
N*	71	80	90	100	125	140	
	2.80	3.15	3.54	3.94	4.92	5.51	
P	9	10	10	15	10	12	
	0.22	0.28	0.28	0.59	0.39	0.47	
Q	56	63	71	80	90	100	
	2.20	2.48	2.80	3.15	3.54	3.94	
R	35	39.5	43.5	58.5	58.5	52	
	1.38	1.56	1.71	2.30	2.30	2.05	
S*	90	100	112	125	140	160	
	3.54	3.94	4.41	4.92	5.51	6.30	
T	112	126	133	160	166	184	
	4.41	4.96	5.24	6.30	6.54	7.24	
U*	5.5	7	7	10	10	12	
	0.22	0.28	0.28	0.39	0.39	0.47	
MOTOR							
GÜÇ	0.12 kW	0.25 kW	0.55 kW	0.75, 1.1 kW	1.5 kW, 2.2 kW	3.0 kW	4.0 kW
ÖLÇÜ	56	63	71	80	90	100	112
ÇARK							
NOMİNAL ÇARK	70	80	98	118	117	125	
OPSİYONEL BAĞLANTILAR							
FLANŞ	-	DN25	DN32 / DN25	DN40 / DN32	DN50 / DN40		
HORİTUM	-	Ø25	Ø25	Ø32 / Ø25	Ø40 / Ø32	Ø50 / Ø40	

Aksi belirtilmedikçe boyutlar mm cinsinde verilmiştir

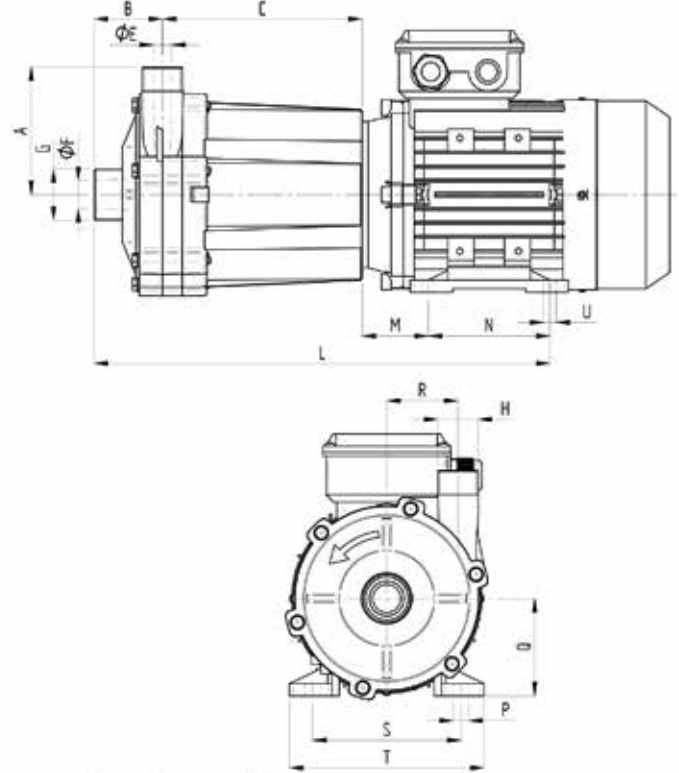

Genel Karakteristikler

Sıcaklık aralığı	PP pompalar: 0°C - 70°C PVDF pompalar: 0°C - 80°C (CTM20); 0°C - 90°C (CTM25, CTM32, CTM42, CTM50)
Sistem basınç sınıfı	CTM20: PP pompalar: PN4 at 20°C, PN2 de 70°C PVDF pompalar: PN4 at 20°C, PN2 de 80°C CTM25, CTM32, CTM40 ve CTM50: PP pompalar: PN6 da 20°C; PN2 de 70°C PVDF pompalar: PN6 da 20°C; PN2 de 90°C
Viskozite	Maksimum 200 cSt
Motor	IEC standardı, 3x400 VAC (diğer voltaj tipleri istek üzerine tedarik edilebilir), 2900 rpm, IP55, yapı şekli B34

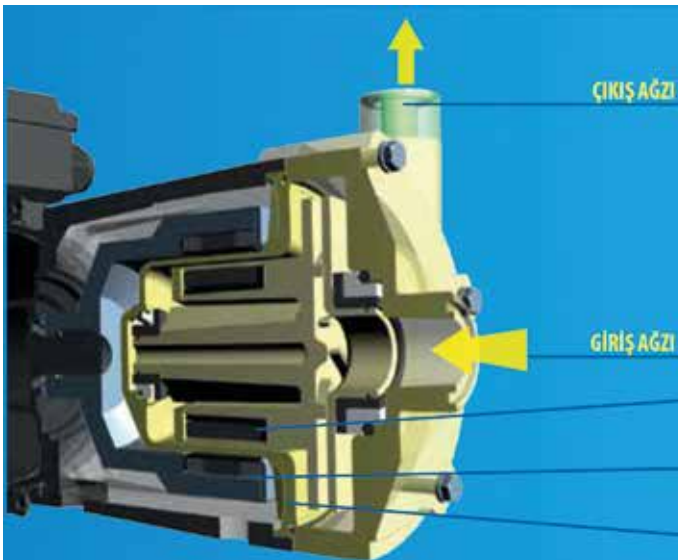

Çalışma Prensibi

Motordan gelen güç, manyetik bir kaplin vasıtasıyla santrifüj çarka aktarılır.

Sürücü mıknatısı ve çark mıknatısı arasında yer alan izolasyon kovani, ıslak kısmı sürücüden ayırır.

ÇARK MIKNATIS DÜZENEGİ

Sürücü mıknatıs düzenegi tarafından tahrik edilir

SÜRÜCÜ MIKNATIS DÜZENEGİ

Motora bağlanır

İZOLASYON KOVANI

(Arka gövde) ıslak kısmı atmosferden ayırır

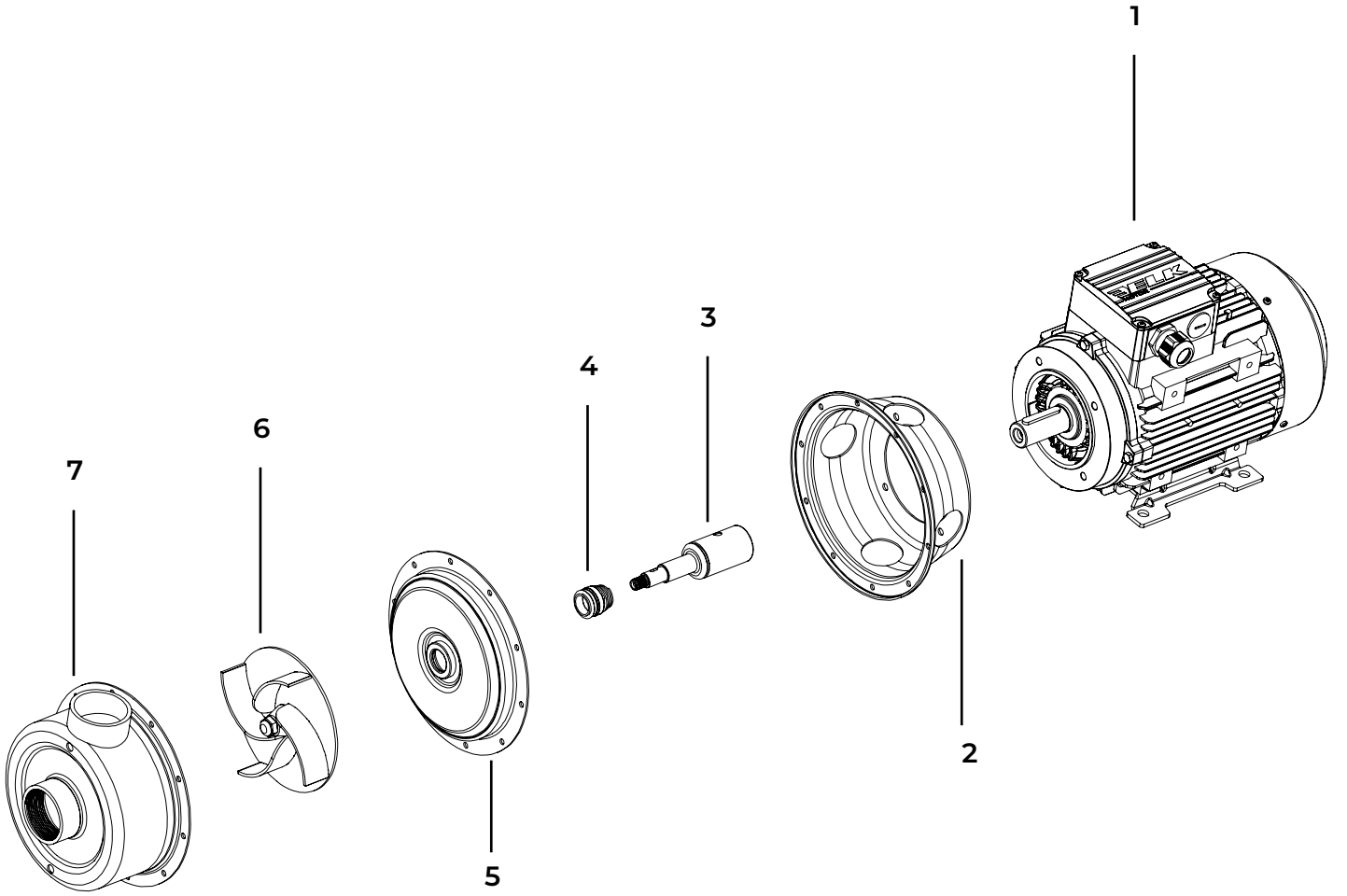

- 1- Motor
- 2- Bağlantı Sacı
- 3- Mekanik Salmastra
- 4- Rijit Geçmeni
- 5- Salmastra Sacı
- 6- Fan
- 7- Gövde



Zirve Pompa ve elik Makina San. Tic. Ltd. Őti.
İkitelli OSB. Mah. Demirciler Sit. D3 Blok Sok. D3 Blok 318B BaŐakŐehir, İstanbul, TURKEY
Tel: +90 212 671 02 57 Gsm: +90 532 682 05 75
info@apexco.com.tr www.apexco.com.tr